

GCC Corner Transom Fitting - Satin Stainless (Model: KGT40SS)



- Easy installation with a unique designed body in three pieces, a great deal of time and effort can be saved by separate installation in side panel and overpanel.

- Same construction for KGT40, KGT40K, KGT41, KGT41K and KGT41KS.

- For Overpanel and Sidepanel With 15mm Diameter Pivot

- Two options in the pivot point, distance from the sidepanel from the frame can be either 55mm or 65mm.

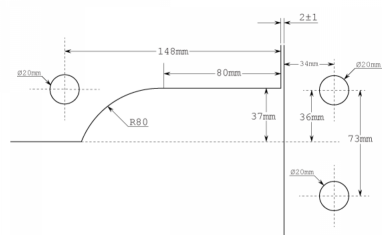
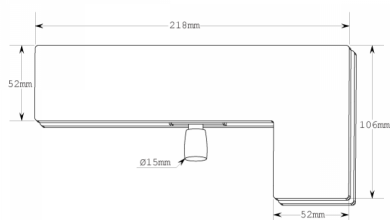

Attributes:

Product Code: KGT40SS

Unit Of Sale: Each

