

Adjustable Wall to Handrail Bracket for Tube 48.3mm x 2.6mm ( Model: KSS.0193.483.316 )

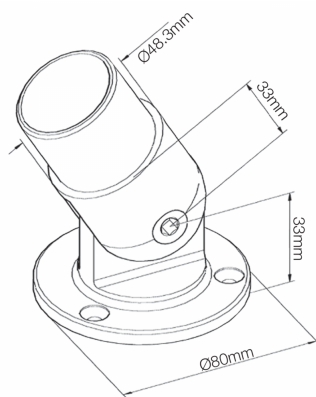

- Suitable for mounting the standard 48.3mm diameter handrail to a wall.
- Supplied in 320 grit polished satin stainless steel.
- Pre drilled for wall fixing.
- Ideal for use on sloping balustrades such as ramps or stairs.



**Attributes:**

**Product Code:** KSS.0193.483.316

**Unit Of Sale:** Each