

Product Update Catalogue 2013

www.glassparts.ie

www.glassparts.co.uk



Also featuring
*Complete Architectural
Glass Fittings Catalogue*

PRODUCT UPDATE CATALOGUE CONTENTS

Glass Cutting & Breaking	Page 4
Glass Lifting & Handling	Page 6
Glass Handling Aids	Page 8
Measuring & Surveying	Page 9
Glazing Tools & Consumables	Page 10
Glass Marking System	Page 13
Sliding Track	Page 14
U Channels	Page 19
Various Profiles	Page 21
Glass Shelving Systems	Page 22
Sign Fixings & Standoffs	Page 25
Cabinet Locks & Hinges	Page 26
UV Furniture Fittings	Page 29
Frameless Shower Hardware	Page 31
Balustrade Clamps & Point Fixings	Page 43
F50 Ezi-Rail Balustrade Post System	Page 47
Crystalline Frameless Balustrade Systems	Page 48
Bi-Fold Sliding Glass Wall System	Page 51
Lever Locks & Receivers Update	Page 54

HEAD OFFICE:

Moneygall Glazing Accessories Ltd
Church Rd
Moneygall
Co. Offaly
Ireland

Phone: 0505 45125
Fax: 0505 45345
Email: sales@glassparts.ie

Web: www.glassparts.ie

UK SALES OFFICE:

GlassParts.co.uk
Kemp House
152 City Road
London
EC1V 2NX

FreeFone: 0800 975 3436
Fax: + 353 505 45345
Email: sales@glassparts.co.uk

Web: www.glassparts.co.uk

Disclaimer: Whilst every effort has been made to make sure all information contained in this catalogue is correct at the time of printing we accept no responsibility or liability for losses caused due to the wrong information been displayed. All sizes and stock availability should be checked before processing any glass. We reserve the right to change or discontinue any product without any notice.

New Websites

DEDICATED WEBSITES FOR IRELAND & UNITED KINGDOM

ADVANCED SEARCH

DEDICATED TRADE LOGIN



MOST POPULAR CATEGORIES

ONLINE COMPANY CATALOGUES

GLASS WEIGHT CALCULATOR

HIGH QUALITY IMAGES



PRODUCT DRAWINGS

RUNNING TOTAL SHOPPING CART

Glass Cutting & Breaking



Toyo TC17B Oil Cutter

Strong & robust brass handle, oil filled glass cutter.

CODE	A0010
REP. HEAD	A0020



Toyo TC17P Oil Cutter

Plastic handle version of the TC17B.

CODE	A0011
REP. HEAD	A0020



Complete Oval & Circle Cutter

For cutting circles and oval shapes accurately and cleanly from 22 - 122cm and for glass up to 19mm thick.

CODE	A0033
------	--------------



Replacement Pad For Oval Cutter

Replacement pad for product A0033. Sold separately.

CODE	A0033A
------	---------------



Replacement Cutting Head

Replacement cutting head for A0033 oval and circle cutter.

CODE	A0033B
------	---------------



Complete Circle Cutter

Complete circle cutter available in various sizes. Suitable for 6 - 12mm thick glass.

600mm	A0058
1200mm	A0059
1600mm	A0060



Replacement Circle Cutter Head

Replacement swivel cutting head for products A0058 - A0060.

CODE	A0062
------	--------------



Replacement Circle Cutter Swivel

Replacement suction circle cutter swivel for products A0058 - A0060.

CODE	A0063
------	--------------



Complete Oil Filled Circle Cutter

Available in three sizes. Suitable for cutting circles in glass 2 - 19mm thick.

600mm	A0065
1200mm	A0066
1600mm	A0067

Glass Cutting & Breaking



Replacement Cutting Head

Replacement oil filled cutting head for products A0065 - A0067.

CODE	A0069A
------	---------------



Replacement Circle Cutter Swivel

Replacement circle cutter suction swivel head for products A0065 - A0067.

CODE	A0070A
------	---------------



Oil Filled Speed Cutter

Available in various sizes.

600mm	A0130
900mm	A0131
1200mm	A0132
1500mm	A0133



Speed Cutter Replacement Head

Replacement complete cutting head for oil filled speed cutters.

CODE	A0134
------	--------------



Replacement Cutting Head

Replacement cutting head for the oil filled speed cutter.

CODE	A0135
------	--------------



Replacement Guide Edge Rollers

Replacement guide edge rollers for the oil filled speed cutters. Sold individually.

CODE	A0136
------	--------------



Speed Cutter Replacement Tape

Suitable for all size speed cutters. Comes complete with adhesive strip on the back of the tape.

CODE	A0137
------	--------------



Toyo TC 20 Glass Cutter

Top quality non oil filled cutter. Manual lubrication. Sturdy wooden handle.

CODE	A0012
Rep. Head	A0021



Cut Running Pliers

Allows for the easy running of cuts in thick glass. Available in two sizes, 5 - 15mm glass and 10 - 25mm glass.

5 - 15mm	A0098
10 - 25mm	A0099

Glass Lifting & Handling



Veribor Aluminium Pump Lifter

Suitable for loads up to 120kg of any flat air tight material such as glass, coated timber, plastic etc.

CODE	B0009
------	--------------



Veribor Plastic Pump Lifter

Suitable for loads up to 120kg of any flat air tight material such as glass, coated timber, plastic etc.

CODE	B0009A
------	---------------



Veribor Plastic Double Lifter

Comes complete with the new integrated vacuum gauges in the levers for added safety. 50kg capacity.

CODE	B0027A
------	---------------



Single Pad Plastic Lifter

Generally used as holding aids for processing glass or carrying small pieces of glass, tile, stone etc. 10kg capacity.

CODE	B0037
------	--------------



Single Pad Aluminium Lifter

Generally used as holding aids for processing glass or carrying small pieces of glass, tile, stone etc. 10kg capacity.

CODE	B0038
------	--------------



Double Pad Plastic Lifter

Suitable for loads up to 25kg of any flat air tight material such as glass, coated timber, plastic etc.

CODE	B0039
------	--------------



Double Pad Aluminium Lifter

Suitable for loads up to 25kg of any flat air tight material such as glass, coated timber, plastic etc.

CODE	B0040
------	--------------



Veribor Triple Aluminium Lifter

Suitable for loads up to 100kg of any flat air tight material such as glass, coated timber, plastic etc.

CODE	B0017
------	--------------



Triple Pad Aluminium Lifter

Suitable for loads up to 35kg of any flat air tight material such as glass, coated timber, plastic etc.

CODE	B0042
------	--------------

Glass Lifting & Handling



10" Pump Lifter

Suitable for loads up to 80kg of any flat air tight material such as glass, coated timber, plastic etc.

CODE	B0073
------	--------------



8" Pump Lifter

Suitable for loads up to 65kg of any flat air tight material such as glass, coated timber, plastic etc.

CODE	B0074
------	--------------



Four Pad Aluminium Lifter

Suitable for loads up to 50kg of any flat air tight material such as glass, coated timber, plastic etc.

CODE	B0075
------	--------------



Replacement Vacuum Piston

Replacement piston for products B0073 & B0074.

CODE	B0079
------	--------------



Replacement Valve

Replacement release valve for products B0073 & B0074.

CODE	B0080
------	--------------



Replacement Pad Pin & Lever

Replacement parts for products B0039, B0040, B0041, B0042 & B0075.

CODE	B0081
------	--------------



8" Pump Lifter

Suitable for loads up to 56kg of any flat air tight material such as glass, coated timber, plastic etc.

CODE	B0086
------	--------------



8" Curved Glass Pump Lifter

Suitable for loads up to 56kg of any slightly curved air tight material such as glass. A popular choice for windscreen installers.

CODE	B0087
------	--------------



10" Pump Lifter

Suitable for loads up to 80kg of any flat air tight material such as glass, coated timber, plastic etc.

CODE	B0088
------	--------------



Vacuum Ratchet Holding Device

Ideal for holding sheet material that is perpendicular to a smooth air tight surface such as splashbacks.

CODE **B0078**



Vacuum Ratchet Joint Closer

Ideal tool for installing glass partitions, glass or stone splashbacks or counters.

CODE **B0079**



Vacuum Screw Type Joint Adjuster

Ideal tool for both pulling together and separating joints in any air tight material such as glass or stone.

CODE **B0080**



Adjustable Angle Suction Brackets

Ideal tool for creating UV or silicone jointed glass boxes or furniture. Adjustable angles from 45° - 270°.

CODE **R0034A**



90° Adjustable Suction Bracket

Ideal tool for creating UV or silicone jointed glass boxes or furniture.

CODE **R0034B**



90° Suction Bracket

Ideal tool for creating UV or silicone jointed glass boxes or furniture.

CODE **R0034C**



90° Suction Bracket

Ideal tool for creating UV or silicone jointed glass boxes or furniture.

CODE **R0034D**



Plate Glass Transporter

Ideal for transporting large pieces of glass up to 2700 x 2700mm. Folds down to 1800 x 430 x 180mm for ease of transport.

CODE **B0051**

Measuring & Surveying



Large Glas-O-Meter

Suitable for measuring the overall thickness of installed sealed units. Now larger for measuring around door section.

CODE	C0018A
------	---------------



Merlin Lazer Measurement Gauge

For measuring the thickness of single, double or triple glazed units in situ. from one side. Also will indicate laminated.

CODE	C0019
------	--------------



Toughened Glass Indicator

Allows the surveyor to check if glass has been toughened (tempered).

CODE	C0020
------	--------------



Low E Coating Detector

To detect the presence and indicates the surface of Low E coating and Pilkington K-Glass in single and double glazing.

CODE	C0021
------	--------------



Glass Analysis Kit

A more cost effective way to purchase the previous three product and includes a handy carry case.

CODE	C0022
------	--------------



Messfix Telescopic Measuring Device

Available in three different lengths.

3 Metre	C0024
4 Metre	C0025
5 Metre	C0026



Messtronic Digital Measuring Device

A digital version of the Messfix device and available in two different lengths.

3 Metre	C0027
5 Metre	C0028



Winkelfix Angle Finder

A must have tool for anybody who measures and installs conservatories or bay windows.

400mm	C0031
600mm	C0032



Winkeltronic Angle Finder

A digital version of the Winkelfix Angle Finder. Easy to read digital display.

450mm	C0033
600mm	C0034

Glazing Tools & Consumables



Winbag - Pump Wedging Device

A quick and handy tool for aiding in the installation of windows. Will lift up to 100kg. Sold in packs of four.

CODE **E0138**



Security Glazing Tape

Double sided glazing tape 10mm high and varying thicknesses, lengths & colours.

3mm x 20 Mtr	Black	E0118
4mm x 15 Mtr	Black	E0119
3mm x 20 Mtr	White	E0120



Foam Glazing Tape

Foam glazing tape 10mm high and varying thickness, lengths & colours.

3mm x 20 Mtr	Black	E0121
4.5 mm x 15Mtr	Black	E0122
3mm x 25Mtr	White	E0123



Heavy Duty Clear Acrylic Tape

Hi bonding clear foamed acrylic tape giving very high performance. Comes with a red plastic liner. 33 metre roll.

0.5mm x 12mm **E0124**

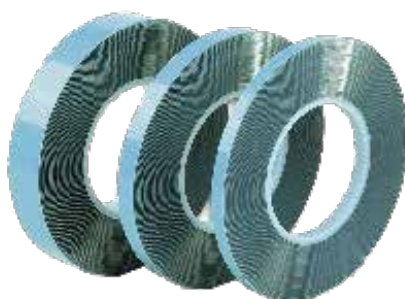

Clear High Bond Double Sided Tape.

Highly transparent polyacrylate based adhesive tape. Ideal for bonding glass, metal, mirrors and many plastics.

6mm	9mm	12mm	15mm
H0309A	H0309	H0310A	H0310



Foam Double Sided Adhesive Tape

Available in different thickness.

Roll	50mtr	40mtr	25mtr
Thick	1mm	2mm	3mm
CODE	H0190	H0192	H0193



Foam Double Sided Adhesive Pads

Foam pads in varying thicknesses. Ideal for temporarily holding mirrors while adhesives cure.

Thick	1mm	1.6mm	3mm
CODE	H0187	H0188	H0189



Foam Transport Pads

20,000 pads per roll. High density PVC foam pads are coated with low peel acrylic adhesive.

CODE **B0055**



Foam Transport Pads

1000 pads per roll. High density PVC foam pads are coated with low peel acrylic adhesive. Sold in boxes of 12 rolls.

CODE **B0056**

Glazing Tools & Consumables



9mm Flat Packers

9mm wide flat packers available in various thicknesses. Ideal for use in U channels.

SIZE	1mm	2mm	3mm
CODE	E0125	E0126	E0127



9mm Flat Packers

9mm wide flat packers available in various thicknesses. Ideal for use in U channels.

4mm	5mm	6mm	10mm
E0128	E0129	E0130	E0131



15mm Flat Packers

15mm wide flat packers in various thicknesses. Ideal for use in U channels.

SIZE	1mm	2mm	3mm
CODE	E0132	E0133	E0134



15mm Flat Packers

15mm wide flat packers in various thicknesses. Ideal for use in U channels.

SIZE	4mm	5mm	6mm
CODE	E0135	E0136	E0137



Geocel Low Modulus Neutral Cure

Ideal for glazing both single and double glazing. Conforms to BS5889 type A and ISO 11600 class 25LM.

Clear	White	Black
NGEOLMNCL	NGEOLMNWH	NGEOLMNBL



Dow Corning 799 Silicone

Dow Corning 799 is a one part, clear neutral curing silicone sealant for use installing coloured glass & double glazing.

Clear	White	Black
NDC799CL	NDC799WH	NDC799BL



Dow Corning 785+ Silicone

Protects against bacteria growth, MRSA, E. Coli, Salmonella and resists mould growth. Ideal for shower installation.

Clear	White
NDC785CL	NDC785WH



Geocel Mirror Fix Silicone Adhesive

High performance silicone adhesive for fixing mirrors. Mirror needs to be supported for 24hours after installation.

CODE	NGEOMIR
------	---------



Dow Corning Firestop 700

Firestop 700 is a one part neutral curing silicone sealant ideal for preventing the spread of smoke and flames.

CODE	N0022
------	-------

Glazing Tools & Consumables



Geocel Aquarium Silicone

Ideal for building small domestic glass aquaria, repairing cracks and sealing connections inside or outside the tank.

CODE	N0016A
------	---------------



The Works Sealant & Adhesive.

Can be used in virtually all areas in both wet and dry. Over paintable, resists mould growth and non shrinking.

Clear	White	Black
NGEOTWCL	NGEOTWWH	NGEOTWBL



Verifix® 2K Acrylate Adhesive

This crystal clear adhesive is suitable for bonding different materials like glass, many metals and some plastics.

Adhesive	Applicator	Nozzles
N0048	N0049	N0050



Geochem Anchor Resin

Geochem Anchor Resin is a rapid curing two-part chemical anchoring cartridge system, applied in one single action to produce a cost effective, tough, chemical resistant fixing. 300ml tube.

CODE	NGEOANCH
------	-----------------



Kwixset Expanding Cement

Kwixset is used for installing frameless glass balustrades. Available in two sizes. Suitable for indoor and outdoor uses.

12kg	N0046
25kg	N0047



Premium Cox Silicone Gun

Top quality Cox Chilton silicone gun for standard 300ml cartridges.

CODE	N0021
------	--------------



Multi Solve Silicone Remover

Silicone and adhesive residue remover. Fast and effective at removing silicone and residue and adhesive left from labels. Can be used on most surfaces.

CODE	NCT1MS
------	---------------

Invisible Shield Surface Protector



Invisible Shield protects surfaces with a water, soil & stain repellent finish that prevents dirt, grime, water spots, minerals and other stains from sticking or building up for easier cleaning. KEEPS SURFACES LIKE NEW - prevents the adhesion and buildup of hard water minerals, soap scum, rust & lime scale. Invisible Shield is the ultimate Shower and Bath Protector. Available in four sizes.

300ml	N0026
500ml	N0027
1 Ltr	N0028
20 Ltr	N0028A

Glass Marking System

Glass Marking System

This is a new option we provide for the glass industry to comply with CE marking requirements. Marks are applied using self-adhesive stencils cut with the required message and safe to handle glass marking fluid that will not harm skin or clothing.

A mark is permanently applied to the glass in just 25 - 90 seconds. The mark is clearer than the old sandblasting technology yet less obtrusive as the mark is more glass coloured than white.

On the right you will see some sample stencils but they can literally be created to suit almost any need and can also include your company logo with a maximum stencil size of 55 x 40mm.

To order all you have to do is tell us what information you would like on your stencil. We draw up a proof and send it to you for approval. Once approved, your order will be produced and sent to you in approximately five working days. The order comes complete with an adequate amount of marking fluid based on your order size and it is included in the price. Please see below the description of how easy it is to create great looking markings on your glass.



STEP 1

Get stencil, marking fluid and brush.



STEP 2

Clean area of glass to be marked with a clean dry cloth. DO NOT wet the glass prior to application of stencils.



STEP 3

Peel off the stencil and retain the backing paper for later use.



STEP 4

Place the adhesive side of the stencil on the glass.



STEP 5

To avoid finger contact with the glass, use the piece of backing material to press the stencil firmly against the surface to ensure a tight bond.



STEP 6

Apply fluid to the stencil with the brush provided, making sure that all the letters and numbers are filled. Do not put outside the stencil.



STEP 7

Leave fluid in place for between 25 and 90 seconds depending on the depth of etch required.



STEP 8

Use water to neutralise the fluid before removing the stencil.



Logo	Design	QTY 100	QTY 250	QTY 500	QTY 1000
LMS00001	LMS00002	LMS00100	LMS00250	LMS00500	LMS01000

Aluminium Sliding Track Top

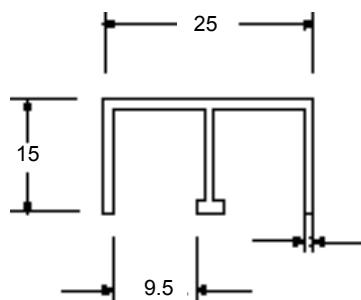

Aluminium sliding track top profile for sliding glass doors using 6mm thick glass. Glass flocked top track reduces movement noise and rattling. Supplied in 2.5 metre lengths. 5 metre lengths available on special request.

Glass Height = Opening Height - 30mm
Glass Width = Ope. Width + 50mm / 2

FINISH	CODE
ANODISED	G0046
BRASS	G0054

Aluminium Sliding Track Bottom

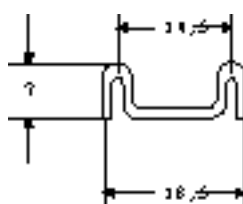

Aluminium sliding track bottom profile for sliding glass doors using 6mm thick glass. Supplied in 2.5 metre lengths. 5 metre lengths available on special request.

Glass Height = Opening Height - 30mm
Glass Width = Ope. Width + 50mm / 2

FINISH	CODE
ANODISED	G0047
BRASS	G0055

Aluminium Sliding Track Shoe

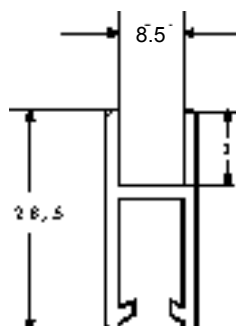

Aluminium sliding track shoe profile for sliding glass doors using 6mm thick glass. Supplied in 2.5 metre lengths. 5 metre lengths available on special request.

Glass Height = Opening Height - 30mm
Glass Width = Ope. Width + 50mm / 2

FINISH	CODE
ANODISED	G0048
BRASS	G0056

Sliding Track Wheel

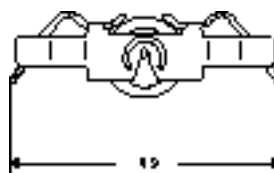

Sliding track wheel with nylon wheel for silent movement of the glass doors. Easily installed in seconds into the track shoe with the wheel insert tool.

CODE	G0049
------	-------

Sliding Track

Aluminium Sliding Track End

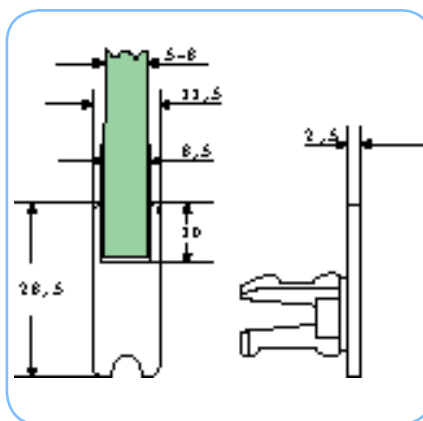

Plastic end cap in the same colour as the main profiles. Can be used on the right or left.

FINISH	CODE
ANODISED	G0050
BRASS	G0057

Aluminium Sliding Track Finger Pull

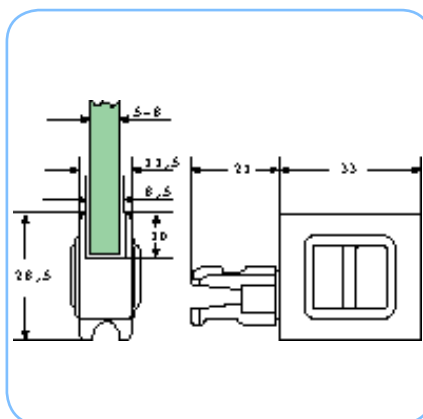

Used instead of the standard open end. This part allows the user to open and close the door using the finger pull slot. This also saves the installer drilling for standard finger pulls.

FINISH	CODE
ANODISED	G0051
BRASS	G0058

Sliding Track Lock - Reversible

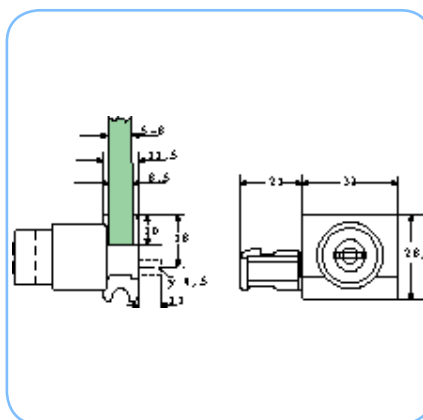

This lock slots into the shoe profile instead of an endcap and allows the user to lock the sliding doors from opening. This lock can be used on the right or left hand side.

FINISH	CODE
ANODISED	G0052
BRASS	G0059

Sliding Track Security Device

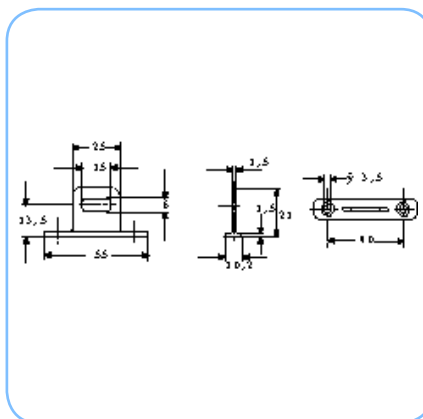

This device is fitted to the track bottom where the doors overlap and then the doors are locked through it preventing the doors been lifted off the track when locked.

CODE	G0061
------	-------

Sliding Track Shoe Gasket

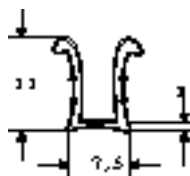

This gasket allows for the easy and clean installation of 6mm thick glass in the shoe profile. To install put the gasket onto the glass and then tap the shoe profile onto the glass. Sold per metre.

CODE	G0060
------	--------------

Sliding Track Wheel Insert Tool



This tool allows for the easy insert of the sliding track wheels into the shoe profile.

CODE	G0053
------	--------------

Sliding Track Single Bottom

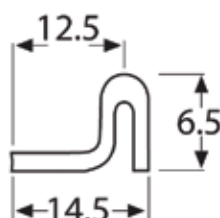

The aluminium sliding track single track bottom enables the use of a third sliding door by fixing alongside the standard bottom track.

CODE	G0047A
------	---------------

Cabinet Sliding Door Finger Pull

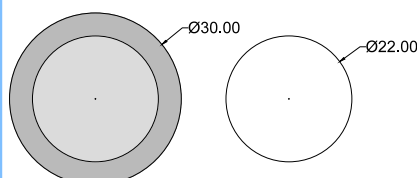

Finger pull for use with sliding doors. Available in polished chrome and brass. Sold in packs of 10.

FINISH	CODE
Chrome	I0036
Brass	I0037

Sliding Track

10mm Glass Sliding Track Top

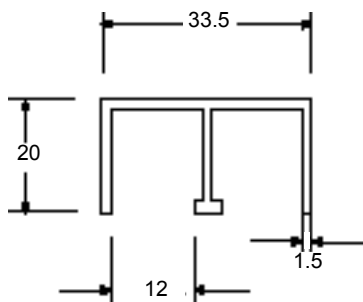

Aluminium sliding track top profile for sliding glass doors using 10mm thick glass. Grass flocked top track reduces movement noise and rattling. Supplied in 5 metre lengths.

CODE | **G0070**

10mm Glass Sliding Track Bottom

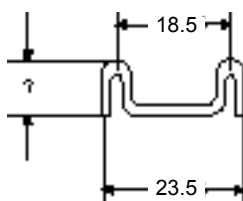
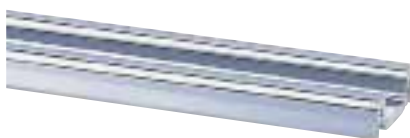

Aluminium sliding track bottom profile for sliding glass doors using 10mm thick glass. Supplied in 5 metre lengths.

CODE | **G0071**

10mm Glass Sliding Track Shoe

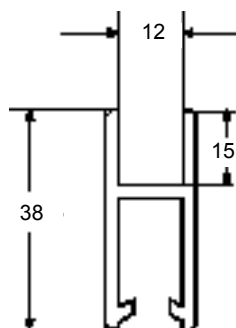

Aluminium sliding track shoe profile for sliding glass doors using 6mm thick glass. Supplied in 5 metre lengths.

CODE | **G0072**

10mm Glass Sliding Track Wheels

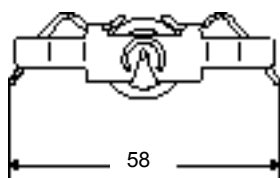

Sliding track wheel with nylon wheel for silent movement of the glass doors. Easily installed in seconds into the track shoe with the wheel insert tool.

CODE | **G0073**

10mm Sliding Track End Caps

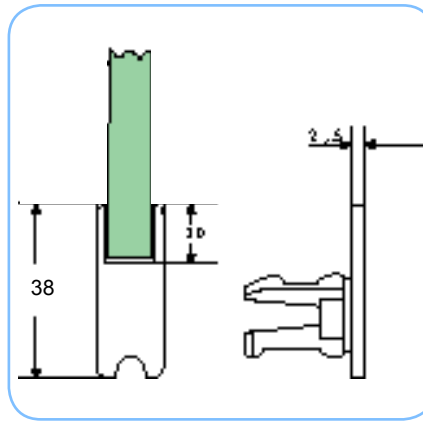

Plastic end cap in the same colour as the main profiles. Can be used on the right or left.

CODE | **G0074**

10mm Glass Sliding Track Lock

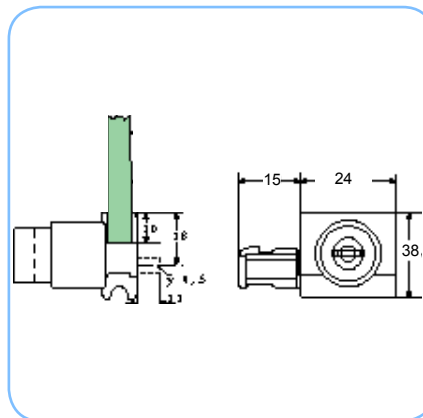

This lock slots into the shoe profile instead of an endcap and allows the user to lock the sliding doors from opening. This lock can be used on the right or left hand side. Lock is not open ended as the image suggests.

CODE | **G0075**

Product Name Wall tot hinge glass

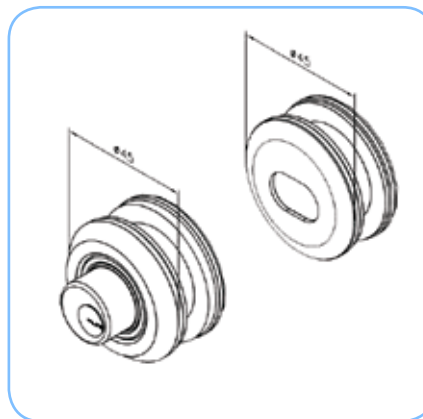

Sliding door lock. For a 70mm overlap in the sliding doors add 140mm to the opening width and divide by two to get the glass width sizes.

Drill a 34mm hole 35mm in from the glass edge to the hole centre.

CODE | **G0080**

Easi-Glide Door Pull

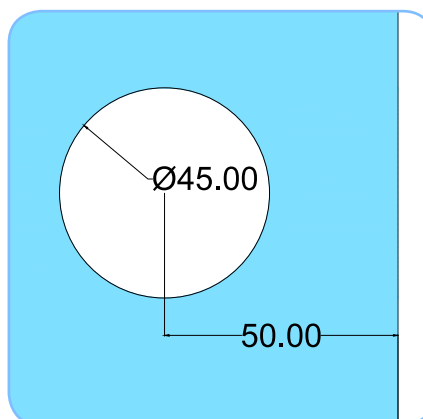

Easi-Glide door pull available in polished chrome. Sold separately. Suitable for 8 - 10mm thick glass.

CODE | **JEGD01**

U Channels

15mm Aluminium U Channel

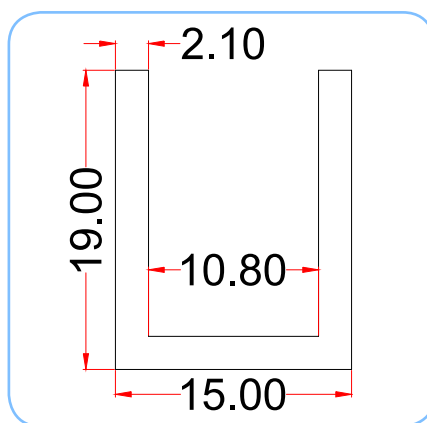

Suitable for 10mm thick glass. Supplied in 2.5 metre lengths. Ideal for use in wet room and shower areas.

FINISH	CODE
POLISHED ALU	G7013
GOLD	G7014

Product Name Wall tot hinge glass

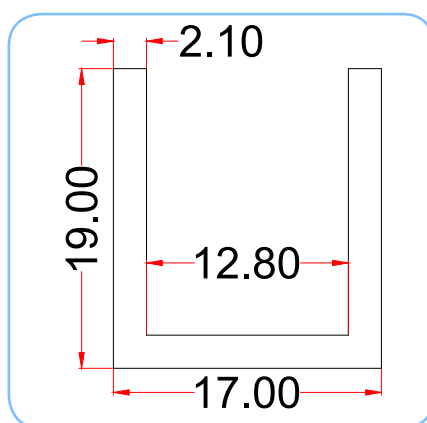

Suitable for 12mm thick glass. Supplied in 2.5 metre lengths. Ideal for use in wet room and shower areas.

FINISH	CODE
POLISHED ALU	G7015
GOLD	G7016

15mm Dry Glaze U Channel

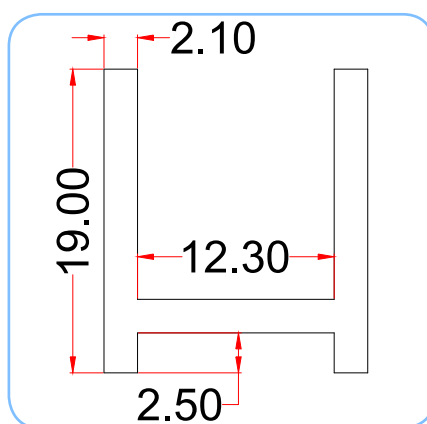

Suitable for 10mm thick glass. Supplied in 2.5 metre lengths. Ideal for use in wet room and shower areas. No need for silicone when installing the glass. Supplied with gasket.

FINISH	CODE
SILVER	G7017
GOLD	G7018

Dry Glaze U Channel End Caps

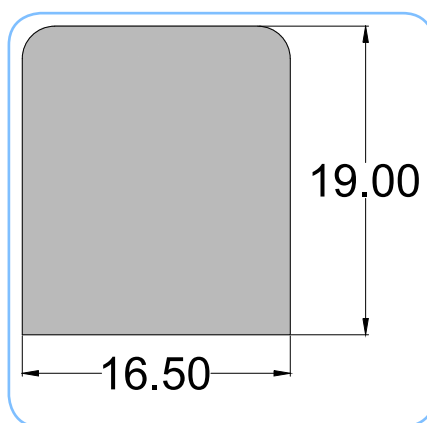

End caps for use with the 15mm dry glaze u channel above.

FINISH	CODE
SILVER	G7019
GOLD	G7020

Dry Glaze Gaskets



Two part gasket system normally used with aluminium channel G7017 & G7018. Supplied in 2.5 metre lengths.

TYPE	CODE
L GASKET	G7021
WEDGE	G7022

Shuffle Glaze U Channel Bottom

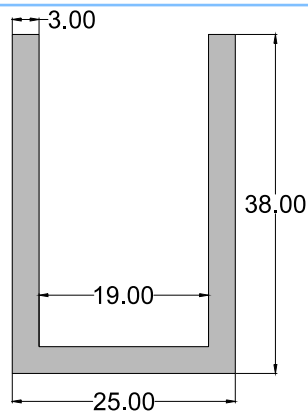

Aluminium U channel suitable for using as a shuffle glaze solution when used with the 50mm U channel below. Can be used as a standard channel with up to 18mm thick glass or as a dry glaze system for either 10mm or 12mm thick glass. Gaskets for 10 or 12mm thick glass sold separately.

FINISH	CODE
SATIN ALUM.	G7028
BRIGHT ALUM.	G7030

Shuffle Glaze U Channel Top

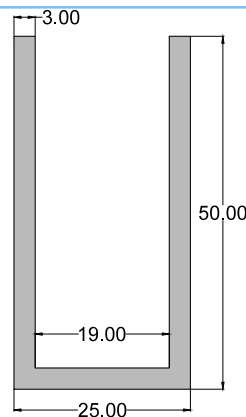

Aluminium U channel suitable for using as a shuffle glaze solution when used with the 38mm U channel above. Can be used as a standard channel with up to 18mm thick glass or as a dry glaze system for either 10mm or 12mm thick glass. Gaskets for 10 or 12mm thick glass sold separately.

FINISH	CODE
SATIN ALUM.	G7029
BRIGHT ALUM.	G7031

Dry Glazing Gaskets

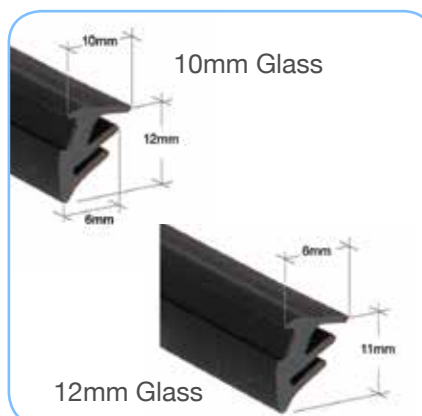
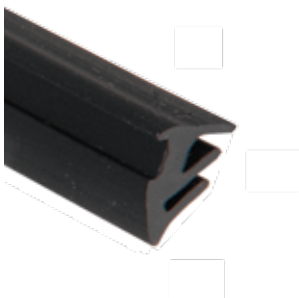

Suitable for using 10mm or 12mm thick glass with the above U channels. Sold per metre.

GLASS SIZE	CODE
10MM	G7032
12MM	G7033

Profiles

Aluminium Right Angle Profile

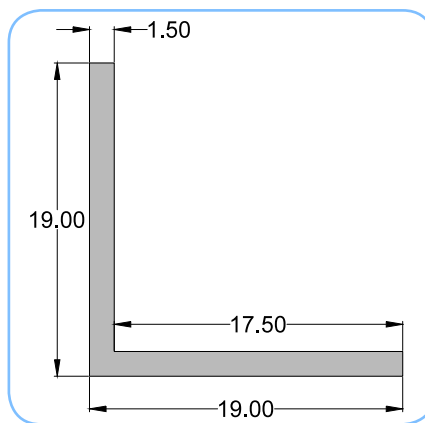

Available in a polished aluminium finish which is similar to polished chrome but more cost effective. Sold in 3.7 metre lengths.

CODE **G0062**

Polished Aluminium Right Angle

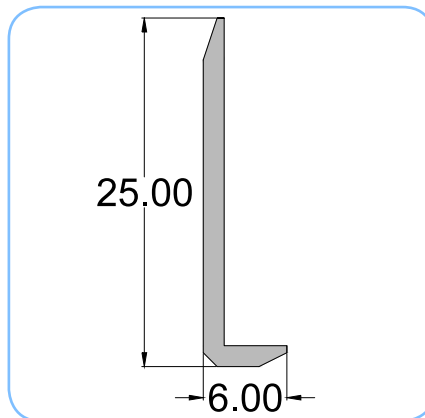

Available in a polished aluminium finish which is similar to polished chrome but more cost effective. Sold in 3.7 metre lengths

CODE **G0043**

Wall Profile System

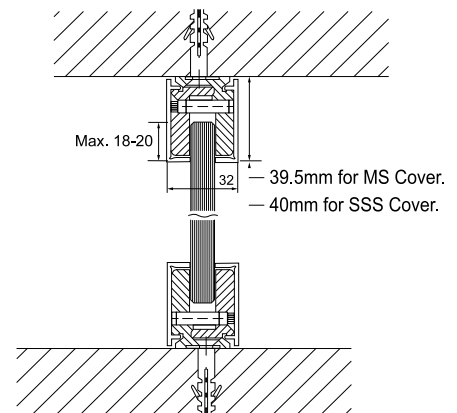
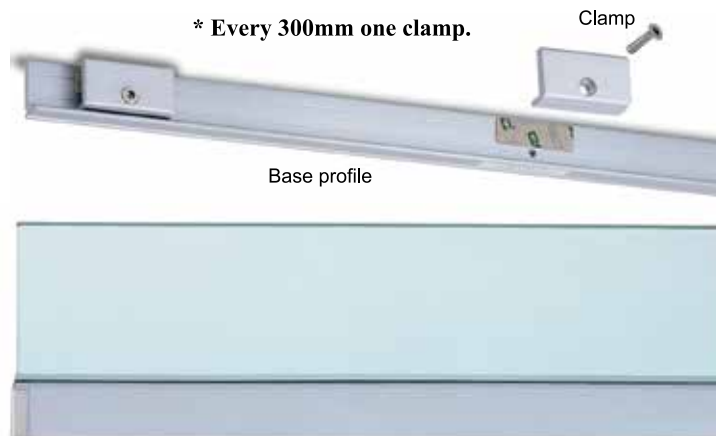

No need for messy sealant, no holes required in the glass. Fast & easy to install. Comes in 3 metre lengths. Supplied with anodised aluminium or stainless steel covers. Suitable for 10 or 12mm thick glass.

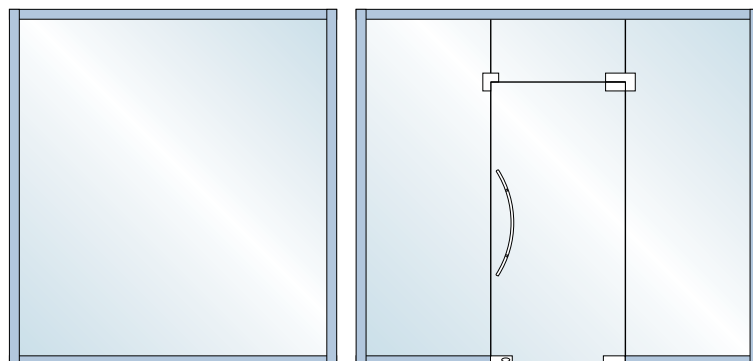

COVERS	THICKNESS	CODE
Aluminium	10mm	KWP10AL
Stainless	10mm	KWP10SS
Aluminium	12mm	KWP12AL
Stainless	12mm	KWP12SS

U

Standard Shelf Grip

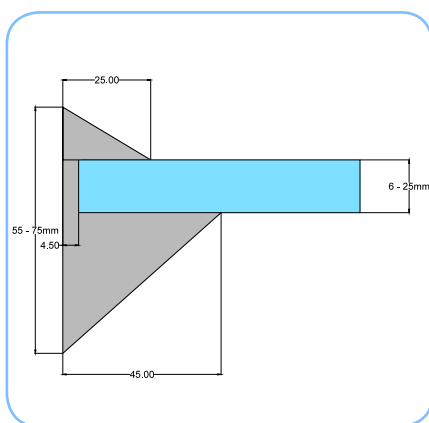

Available in a number of finishes. Suitable for material up to 25mm thick. Ideal for glass, metal or timber shelves. Sold in pairs. Other finishes may be available on request.

CHROME	H0013
WHITE	H0014
BLACK	H0016

Mini Shelf Grip

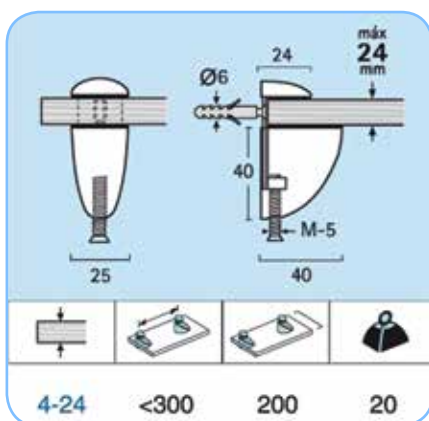

Available in a number of finishes. Suitable for material up to 24mm thick. Ideal for glass, metal or timber shelves. Sold in pairs.

CHROME	H0029
BRASS	H0208
WHITE	H0209
BLACK	H0210

Midi Shelf Grips

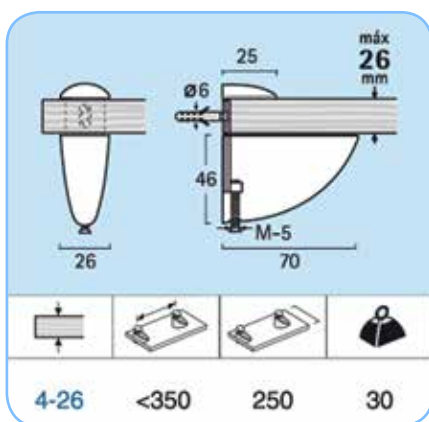

Available in polished chrome. Suitable for material up to 26mm thick. Ideal for glass, metal or timber shelves. Heavy duty shelf brackets. Sold in pairs.

CHROME | H0029A

Glass Shelf Support System

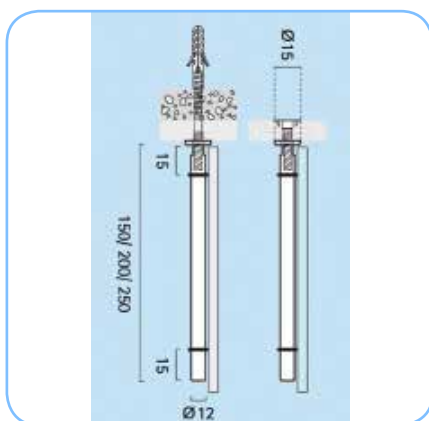

Contemporary shelving system available in a polished chrome finish. Available in three lengths and come complete with fixings for mounting into a wall or through sheet material.

150MM	H0300
200MM	H0301
250MM	H0302

Glass Shelving Systems

Round Shelf Support

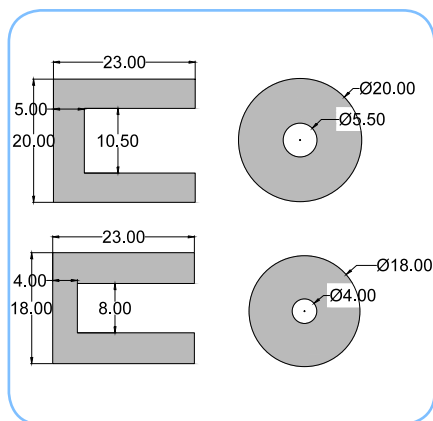

Available in two sizes for both 6mm and 10mm thick glass. One of the most popular shelf brackets due to its simple nature. Sold in pairs and available in polished chrome.

GLASS SIZE	CODE
10MM	H0027
6MM	H0207

Glass Shelf Support

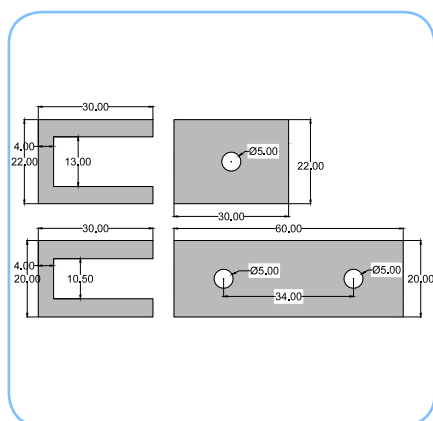

Available in two different sizes and suitable for 8 - 12mm thick glass. Supplied in polished chrome and sold in pairs.

SIZE	CODE
30 x 30mm	H0323
30 x 60mm	H0324

Glass Shelf Support

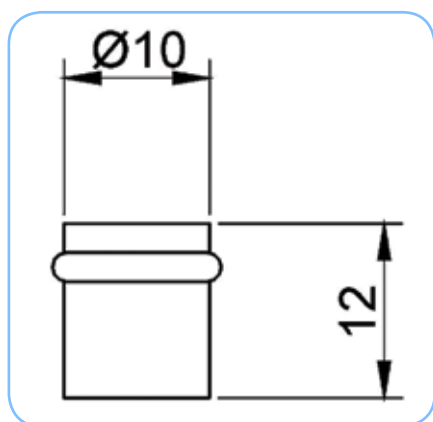

Glass shelf support for mounting glass shelves in a timber cabinet. Concentric drilling for easy adjustment of height. Supplied in a polished chrome finish and sold separately.

CODE	H0223
------	--------------

Heavy Duty Glass Shelving System

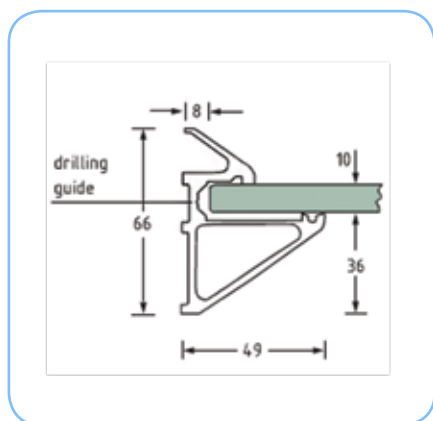
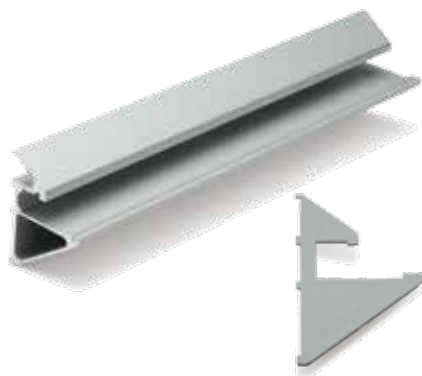

Heavy duty glass shelving profile. Suitable for 10mm thick glass and supplied in an anodised aluminium finish. 5 metre lengths. End cap sold separately.

Carrying capacity:
Shelf Depth of 300mm = 50 kg/m
Shelf Depth of 400mm = 32 kg/m
When fixed every 500mm approximately.

PRODUCT	CODE
PROFILE	H20077238
END CAP	H20078649

Glass Shelving Systems

Glass Cabinet Shelf Support

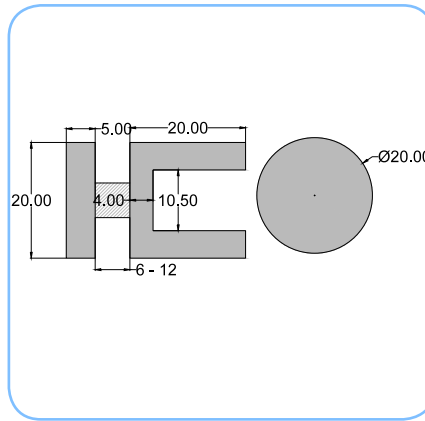

Polished chrome finish. Can be mounted on glass up to 12mm thick with a maximum thickness of 10mm glass shelf. Drill 10mm hole for mounting on side. Non Drill for mounting shelf.

CODE | **H0325**

Glass Cabinet Dual Shelf Support

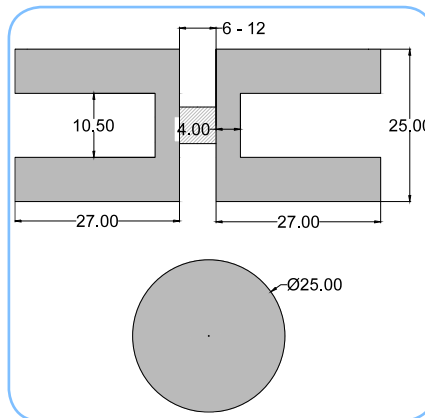

Polished chrome finish. Can be mounted on glass up to 12mm thick with a maximum thickness of 10mm glass shelf. Drill 10mm hole for mounting on side. Non Drill for mounting shelf.

CODE | **H0326**

Chrome Slotted Wall Channel

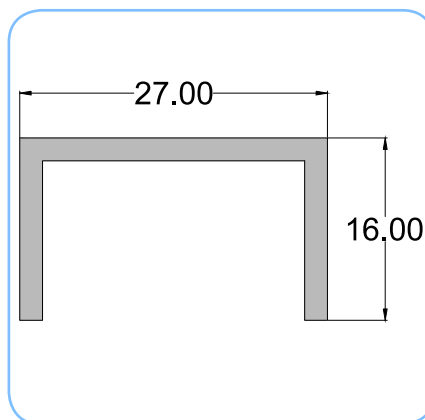

Sold in 2390mm lengths in polished chrome. Very versatile shelving system as shelves can be moved to suit the application. Easily fixed to wall through the pre-drilled holes in the profile. Slotted wall channel with double slots at 32mm pitch with a section of 27mm wide x 16mm deep.

CODE | **HTS001CH**

Chrome Shelf Brackets

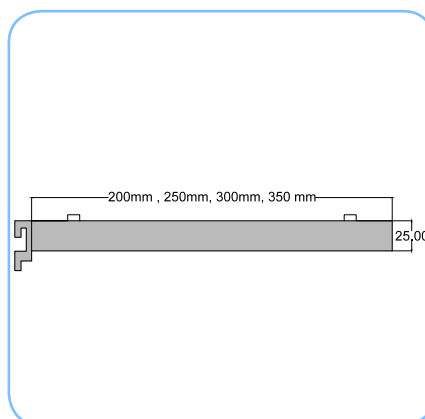

Polished chrome shelf brackets for use with the slotted wall channel above. Supplied with silicone buffers on the brackets to stop the glass slipping. Available in four sizes.

200mm	HTS002CH
250mm	HTS003CH
300mm	HTS004CH
400mm	HTS005CH

Sign Fixings & Standoffs

30mm Chrome Plated Standoffs

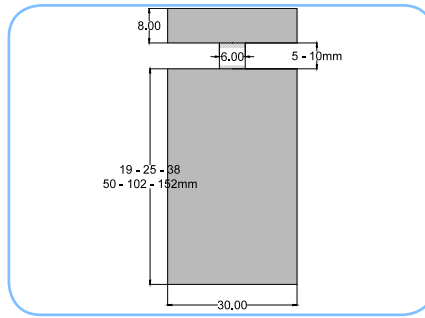

30mm in diameter and available in six different heights. Easily mounted to any surface.

19mm	25mm	38mm	50mm	102mm	152mm
H0217	H0218	H0219	H0220	H0221	H0222

19mm Chrome Plated Standoffs

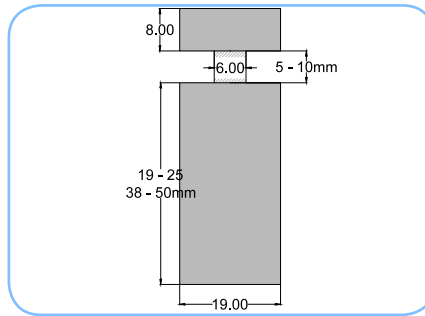

19mm in diameter and available in four different heights. Easily mounted to any surface.

Size	19mm	25mm	38mm	50mm
CODE	H0224	H0225	H0226	H0227

30mm Stainless Steel Standoffs

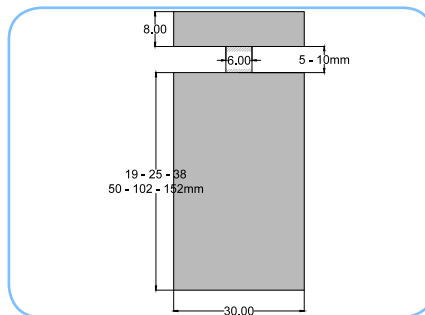

30mm in diameter and available in six different heights. Easily mounted to any surface.

19mm	25mm	38mm	50mm	102mm	152mm
H0311	H0312	H0313	H0314	H0315	H0316

Countersunk 30mm Standoffs

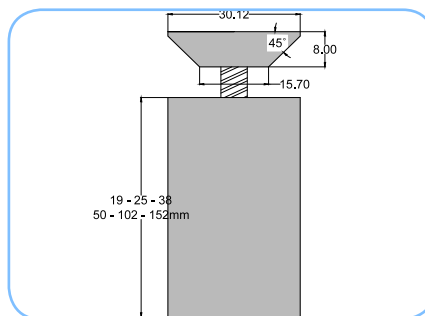

30mm in diameter stainless steel and available in six different heights. Easily mounted to any surface.

19mm	25mm	38mm	50mm	102mm	152mm
H0317	H0318	H0319	H0320	H0321	H0322

Cabinet Locks & Hinges

Non Drill Single Door Lock

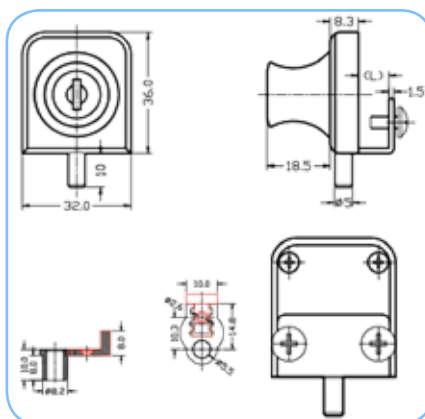

New pin type non drill cabinet door lock with receiver. Can be used with inset or overlay hinges. Suitable for up to 6mm thick glass. Available in polished chrome.

CODE | I0013A

Non Drill Double Door Lock

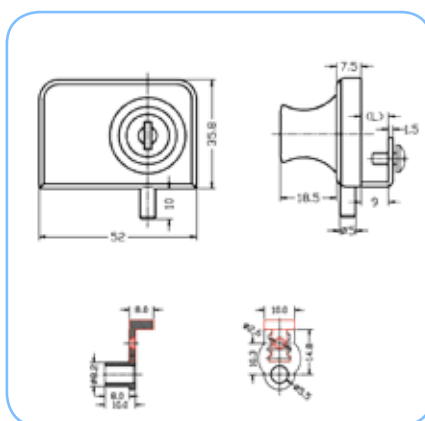

New pin type non drill double door cabinet door lock with receiver. Can be used with inset or overlay hinges. Suitable for up to 6mm thick glass. Available in polished chrome.

CODE | I0015A

Non Drill Glass To Glass Lock

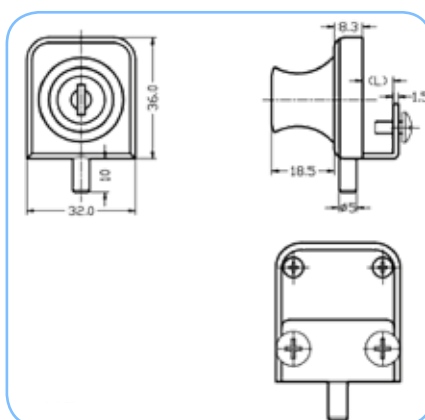

New non drill glass to glass lock. For use where a cabinet has a glass side, top or bottom panel. Suitable for 6mm thick glass.

CODE | 10079

Glass Cabinet Lock

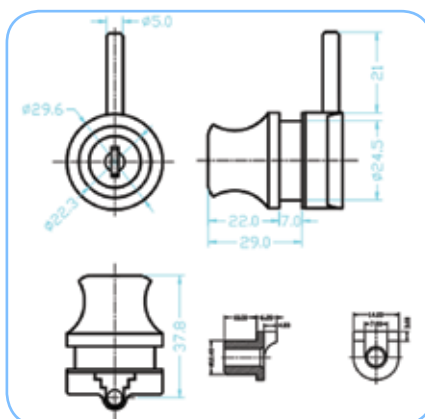

Pin type single swing door lock with
recesses floor receiver. Suitable for 6mm
thick glass. Drill 26mm diameter hole.

Chrome	10011
Gold	10012

Cabinet Locks & Hinges

Stainless Steel Non Drill Hinge

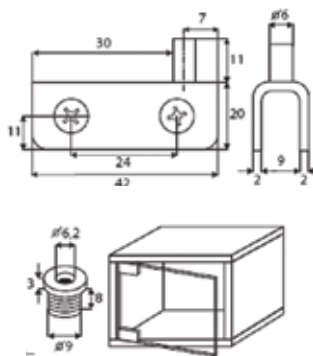

Suitable for 6mm thick glass. Comes complete with brass bushings and soft tip screws. Drill a 9mm diameter by 8mm deep hole for the hinge bushing. Available in a polished stainless steel finish and sold in pairs.

CODE | 10074

Stainless Steel Non Drill Hinge

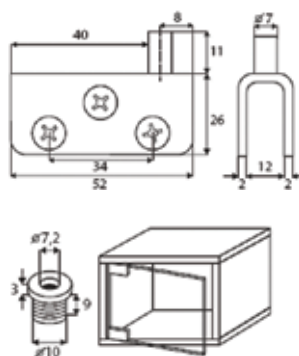

Suitable for 8mm thick glass. Comes complete with brass bushings and soft tip screws. Drill a 10mm diameter by 9mm deep hole for the hinge bushing. Available in a polished stainless steel finish and sold in pairs.

CODE | 10075

Stainless Steel Non Drill Hinge

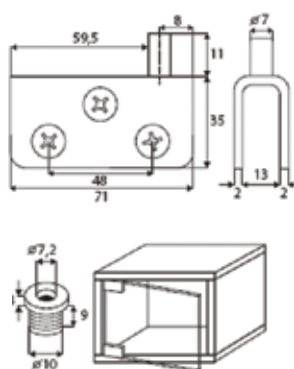
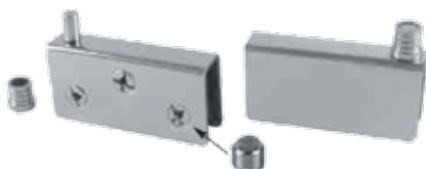

Suitable for 10mm thick glass. Comes complete with brass bushings and soft tip screws. Drill a 10mm diameter by 9mm deep hole for the hinge bushing. Available in a polished stainless steel finish and sold in pairs.

CODE | 10076

Overlay Drilled Glass Door Hinge

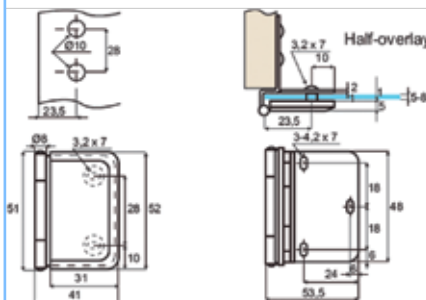

Overlay drilled glass door hinge. Suitable for 5 - 8mm thick glass and maximum of 12kg per pair. Polished chrome finish and sold in pairs.

CODE | 10077

U

Inset Drilled Glass Door Hinges

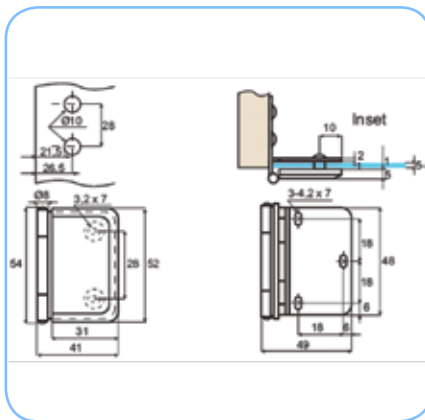

Inset drilled glass door hinge. Suitable for 5 - 8mm thick glass and maximum of 12kg per pair. Polished chrome finish and sold in pairs.

CODE 10078

180° Non Drill Glass to Glass Hinge

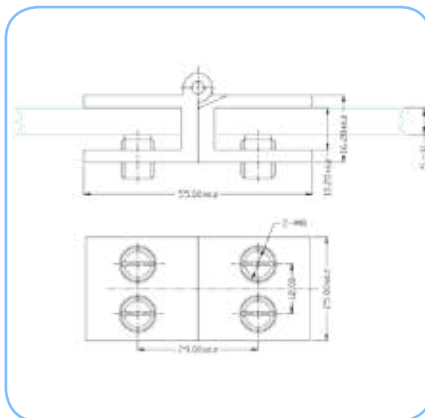

Suitable for 6 - 8mm thick glass up to 10kg per pair. Polished chrome finish and sold in pairs.

CODE 10080

Non Drill Wall to Glass Hinge

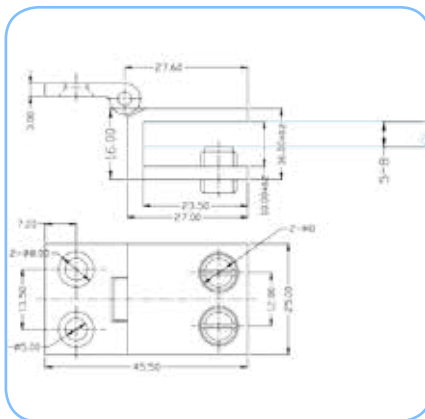

Suitable for 6 - 8mm thick glass up to 10kg per pair. Polished chrome finish and sold in pairs.

CODE I0081

90° Non Drill Glass to Glass Hinge

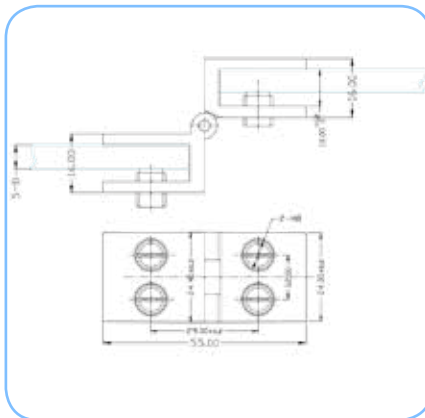

Suitable for 6 - 8mm thick glass up to 10kg per pair. Polished chrome finish and sold in pairs.

CODE 10082

UV Furniture Fittings

UV Glass to Timber Hinges

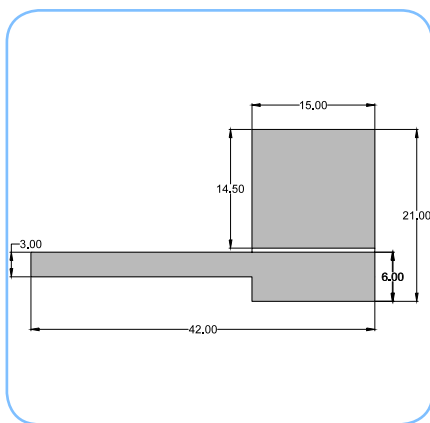

UV glass to timber hinges, suitable for use where there is a glass door and a timber or other solid material top and bottom. 304 stainless steel and available in satin and polished stainless steel.

FINISH	CODE
SSS	IUV001
PSS	IUV002

UV Glass to Glass Hinges

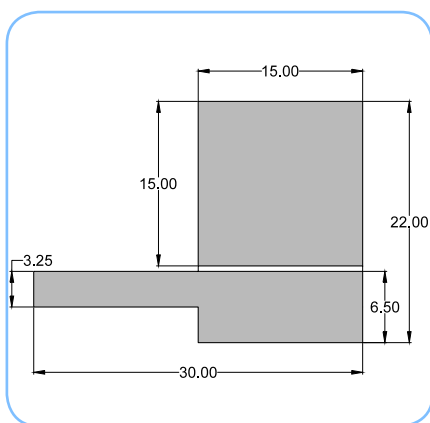

UV glass to glass hinges, suitable for use where there is a glass door and a glass top and bottom. 304 stainless steel and available in satin and polished stainless steel.

FINISH	CODE
SSS	IUV003
PSS	IUV004

UV Inset Lock & Receiver

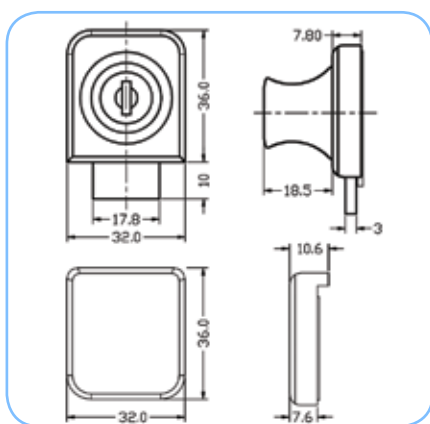

Suitable for inset doors. Used when a door is closing into a fixed panel at 90°. Available in polished and satin chrome finishes.

FINISH	CODE
Polished	IUV010
Satin	IUV011

UV Overlay Lock & Receiver

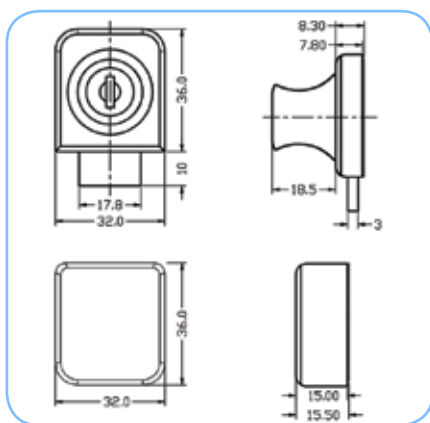

Suitable for overlay doors. Used when a door is closing into a fixed panel at 90°. Available in polished and satin chrome finishes.

FINISH	CODE
Polished	IUV012
Satin	IUV013

180° UV Lock & Receiver

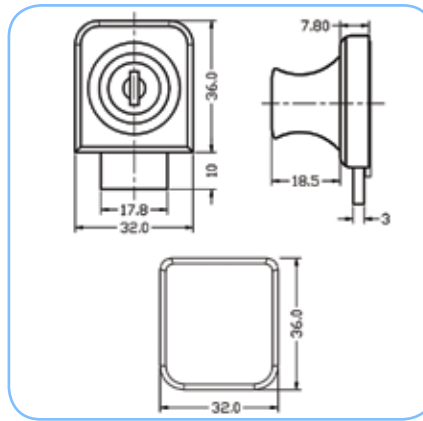

Suitable for a door running at 180° to another door or fixed panel. Available in polished and satin chrome finishes.

FINISH	CODE
Polished	IUV014
Satin	IUV015

UV Bolt Lock

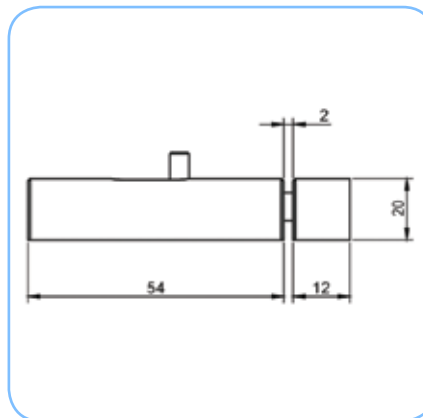

Suitable for creating a fixed panel so that another door can be locked to it. Can be used with or without the receiver. Available in satin stainless steel only.

CODE	I0072
------	--------------

UV Standoffs

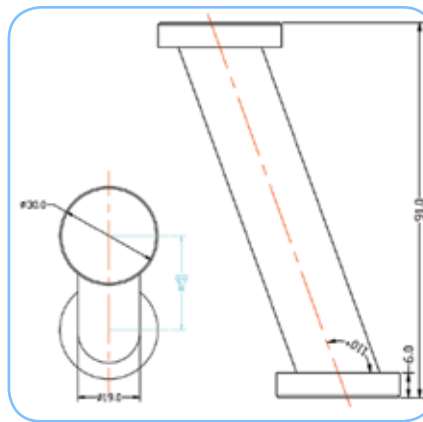

Stainless steel UV standoffs. 30mm diameter base and bonding top with a 19mm diameter tube. Overall height of 91mm. Available in both polished and satin finishes.

FINISH	CODE
Polished	IUV022
Satin	IUV023

UV Bonding Table Legs

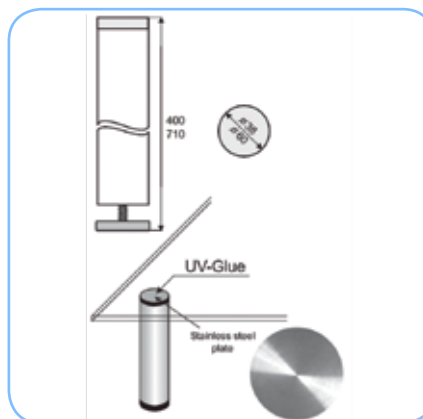

Available in two lengths, 400mm and 700mm. Comes with adjustable feet for levelling. Stainless steel bonding plate with polished chrome legs and black adjustable feet.

SIZE	CODE
400mm	IUV024
710mm	IUV025

Frameless Shower Hardware

Easi-Glide Glass to Glass Kit

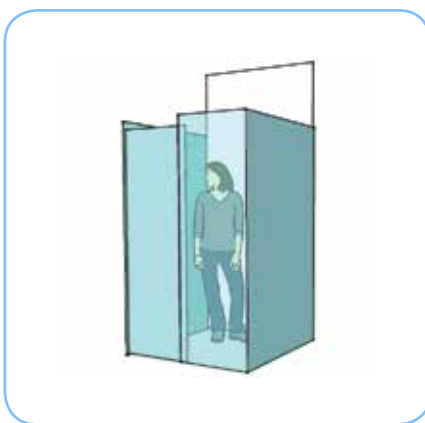

Complete Easi-Glide glass to glass kit. Used where there are two fixed glass side panels. Available in polished chrome. Maximum width 1250mm

Includes: 2 door hangers, sliding track, 2 sliding track ends to glass connectors, 2 fixed panel connectors, 1 door pull and 1 bottom guide.

Fixed panel brackets sold separately.

CODE **JEG-G2G-KIT**

Easi-Glide Wall to Glass Kit

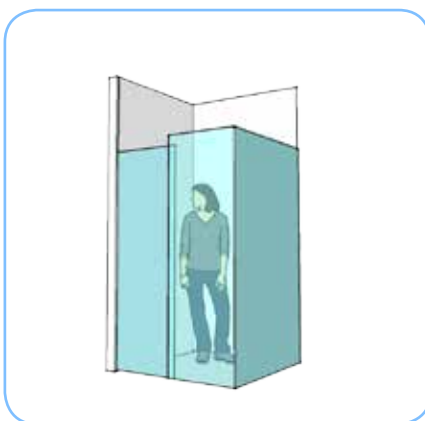

Complete Easi-Glide wall to glass kit. Used where there is one fixed glass side panel and a wall on the opposite side. Available in polished chrome. Maximum width 1250mm

Includes: 2 door hangers, sliding track, 1 sliding track ends to glass connector, 1 wall to track connector, 2 fixed panel connectors, 1 door pull and 1 bottom guide. Fixed panel brackets sold separately.

CODE **JEG-W2G-KIT**

Easi-Glide Wall to Wall Kit

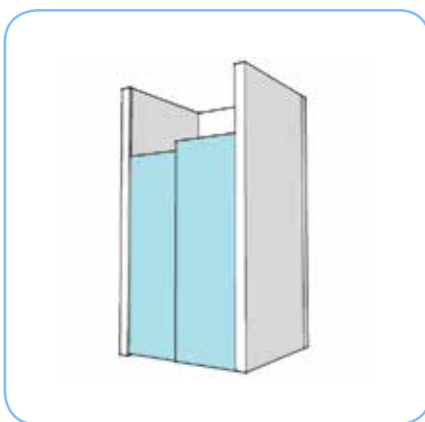

Complete Easi-Glide wall to glass kit. Used where there is one fixed glass side panel and a wall on the opposite side. Available in polished chrome. Maximum width 1250mm

Includes: 2 door hangers, sliding track, 2 wall to track connectors, 2 fixed panel connectors, 1 door pull and 1 bottom guide.

Fixed panel brackets sold separately.

CODE **JEG-W2W-KIT**

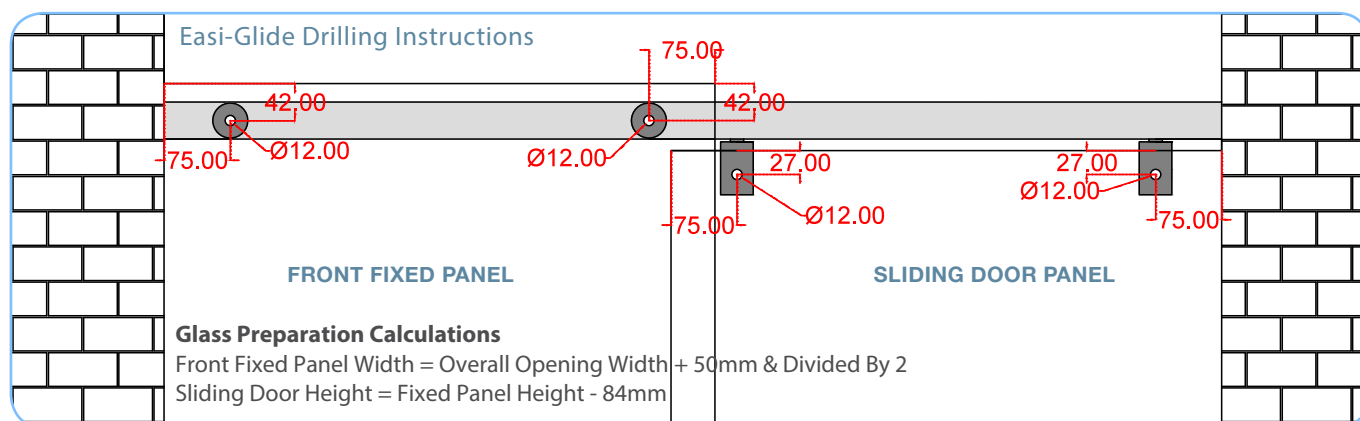

Frameless Shower Hardware

Easi-Glide Roller Hanger

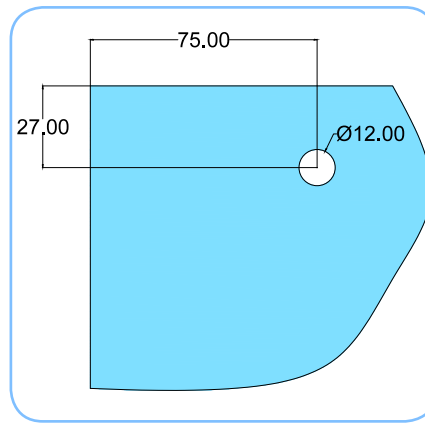

Easi-Glide roller hanger. Suitable for 8 - 10mm thick glass. Nylon wheels for silent and smooth movement. Polished chrome finish and sold in pairs.

CODE | **JEGC01**

Easi-Glide Fixed Panel Bracket

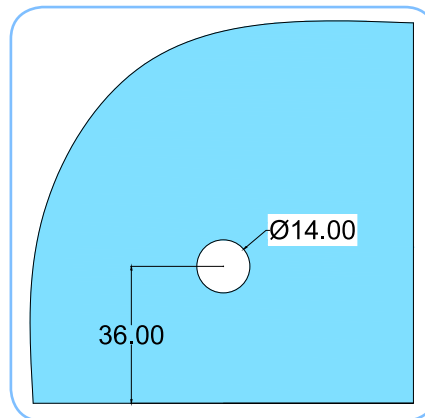

Suitable for 8 - 10mm thick glass. Polished chrome finish and sold separately.

CODE | **JEGC02**

Easi-Glide Panel to Track Fixing

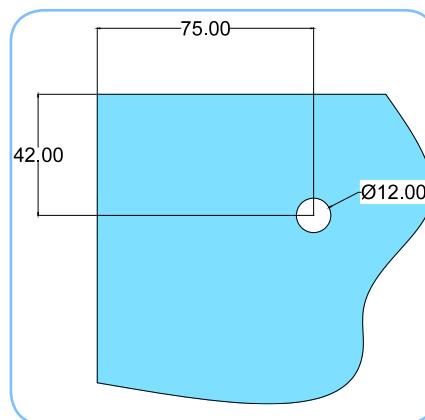

Suitable for 8 - 10mm thick glass. Polished chrome finish and sold separately.

CODE | **JEGC03**

Easi-Glide Side Panel To Track Fixing.

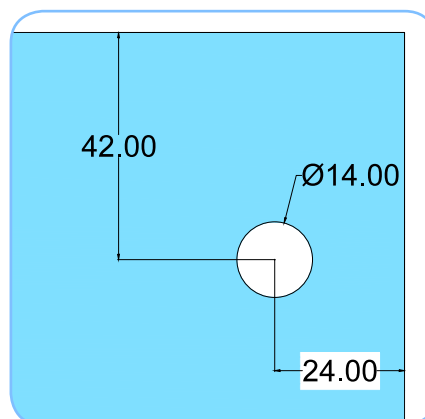

Suitable for 8 - 10mm thick glass. Polished chrome finish and sold separately.

CODE | **JEGC04**

Frameless Shower Hardware

Easi-Glide Floor Guide

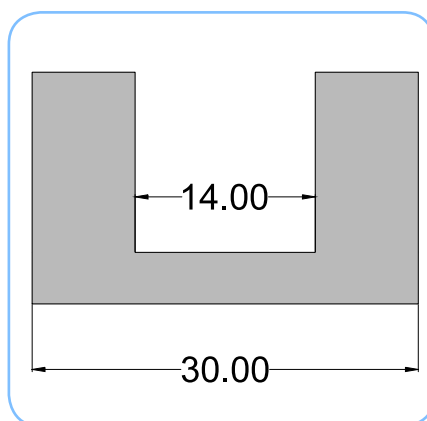

Easi-Glide floor guide. Suitable for 8 - 10mm thick glass. Polished chrome finish and sold separately.

CODE | **JEGC06**

Easi-Glide Track Stopper



Heavy duty black stopper that fits easily into the Easi-Glide sliding track. One needed for both the open and closed position. Designed to also act as a holding device.

CODE | **JEGC07**

Easi-Glide Wall to Track Fixing

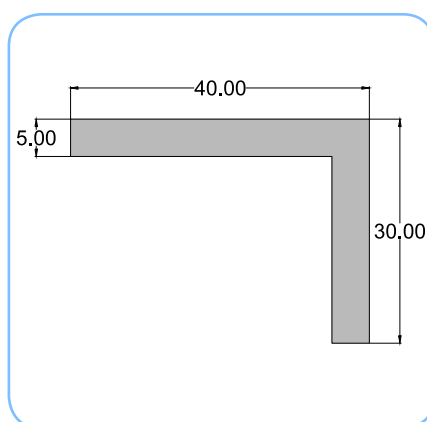

Bracket for mounting the Easi-Glide sliding track to a wall. Hidden fixing that is fixed inside the track.

CODE | **JEGC08**

Easi-Glide Sliding Door Track

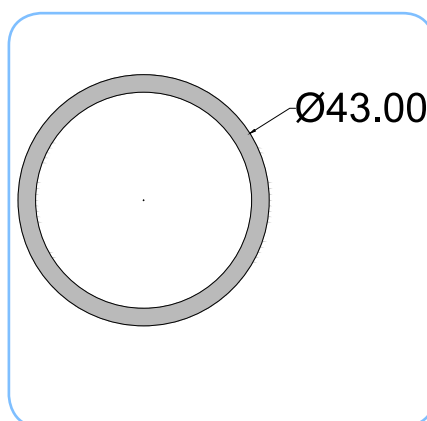

Available in 1.25 metre lengths as standard. 2.5 metre lengths available on request. Polished aluminium finish.

CODE | **JEGC09**

Frameless Shower Hardware

Easi-Glide Door Pull

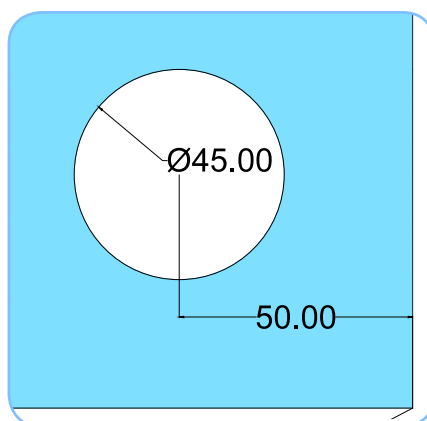

Easi-Glide door pull available in polished chrome. Sold separately. Suitable for 8 - 10mm thick glass.

CODE	JEGD1
------	--------------

Wall to Glass Shower Hinge

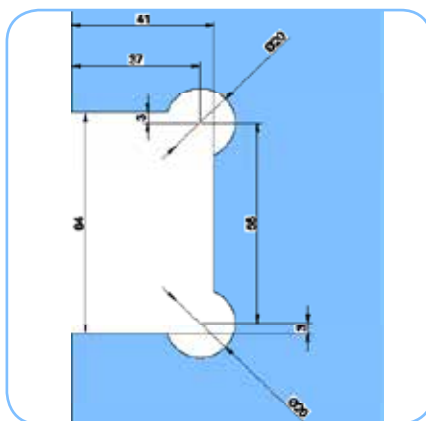

Self closing from 30°. Opens in both directions. Suitable for glass thickness 8 - 12mm. Maximum weight up to 45kg per pair. Complete with stainless steel screws and wall plugs. Available in polished and satin chrome.

FINISH	CODE
Polished	JHI301PC
Satin	JHI301SC

135° Glass to Glass Shower Hinge

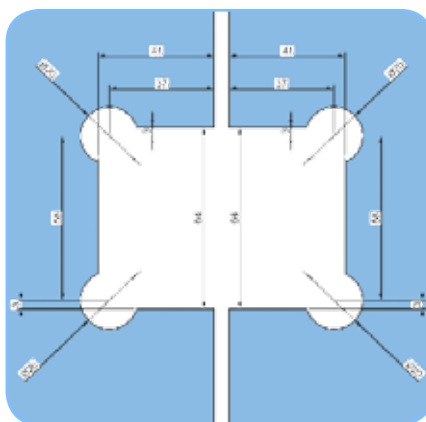

Self closing from 30°. Opens in both directions. Suitable for glass thickness 8 - 12mm. Maximum weight up to 45kg per pair.

Please note that for this assembly type the hinge edge of the door must be mitred at 45°.

FINISH	CODE
Polished	JHI302PC
Satin	JHI302SC

180° Glass to Glass Shower Hinge

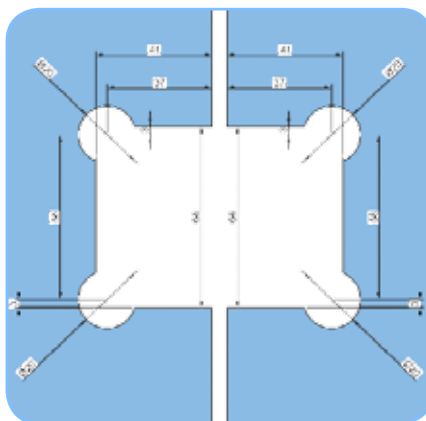

Self closing from 30°. Opens in both directions. Suitable for glass thickness 8 - 12mm. Maximum weight up to 45kg per pair.

FINISH	CODE
Polished	JHI303PC
Satin	JHI303SC

Frameless Shower Hardware

90° Glass to Glass Shower Hinge

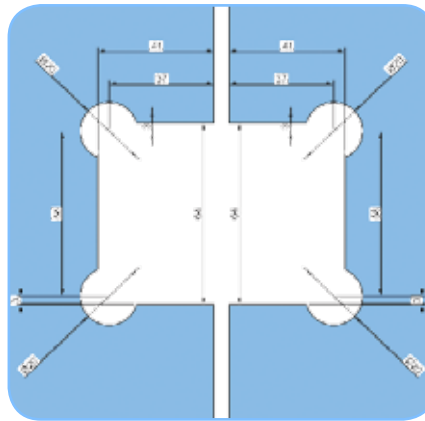

Self closing from 30°. Suitable for glass thickness 8 - 12mm. Maximum weight up to 45kg per pair.

FINISH	CODE
Polished	JHI304PC
Satin	JHI304SC

UV Glass to Glass Hinges

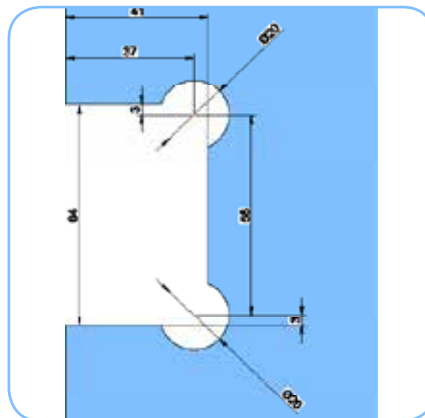

Self closing from 30°. Opens in both directions. Suitable for glass thickness 8 - 12mm. Maximum weight up to 45kg per pair. Complete with stainless steel screws and wall plugs. Available in polished and satin chrome.

FINISH	CODE
SSS	JHI305PC
PSS	JHI305SC

Shower Hinge

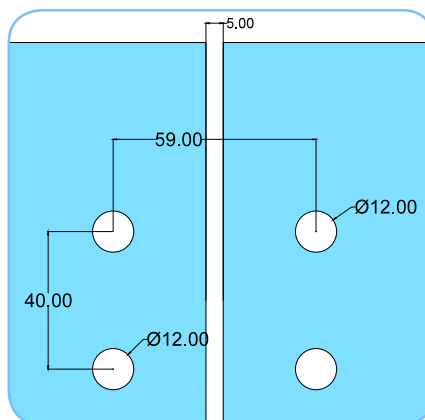

Free swinging glass to glass hinge with no closing mechanism. Suitable for 8 - 10mm thick glass and available in polished chrome. Hinge size: 105mm x 80mm.

FINISH	CODE
Polished	JHI110

Glass to Glass 180° Rise/Fall Hinge

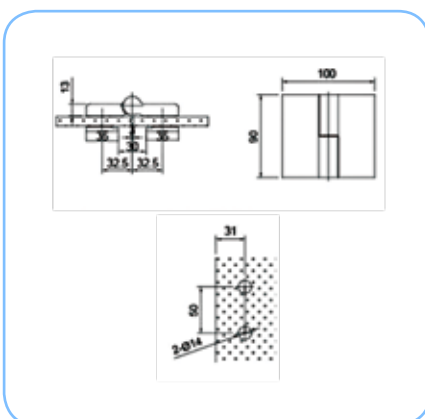

180° glass to glass rise/fall hinge. Available in right and left hand hinges. Auto closing due to the rise/fall mechanism.

SIDE	CODE
Left	JSHL180L
Right	JSHL180R

Frameless Shower Hardware

Wall to Glass 90° Rise/Fall Hinge

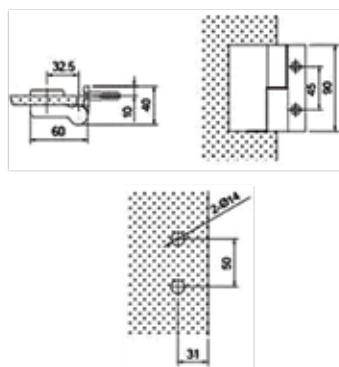

90° wall to glass rise/fall hinge. Available in right and left hand hinges. Auto closing due to the rise/fall mechanism.

FINISH	CODE
Left	JSHL90L
Right	JSHL90R

Wall to Glass Shower Fixing

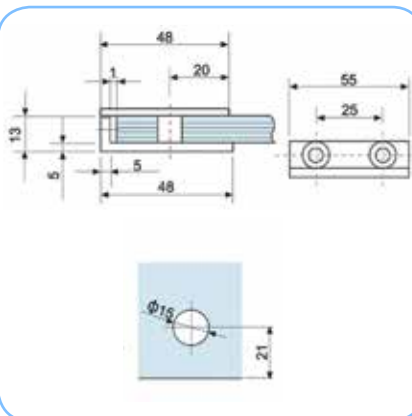

Suitable for glass thickness 6 - 10mm. Available in polished and satin chrome. Sold separately.

FINISH	CODE
Polished	JH701PC
Satin	JH701SC

90° Wall to Glass Shower Fixing

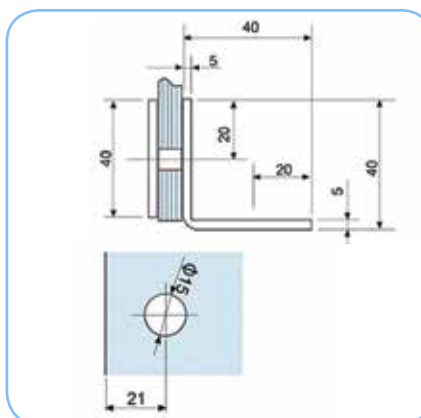

Suitable for glass thickness 6 - 10mm. Available in polished and satin chrome. Sold separately.

FINISH	CODE
Polished	JH702PC
Satin	JH702SC

180° Wall to Glass Shower Fixing

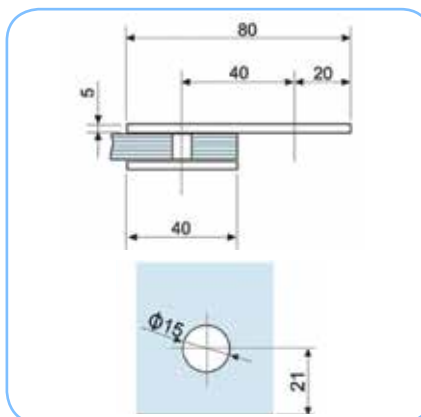

Suitable for glass thickness 6 - 10mm. Available in polished and satin chrome. Sold separately.

FINISH	CODE
Polished	JH703PC
Satin	JH703SC

Frameless Shower Hardware

180° Glass to Glass Shower Fixing

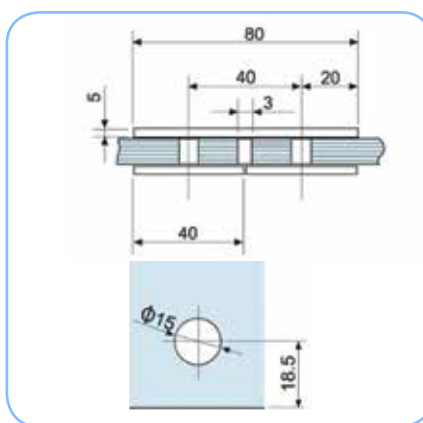

Suitable for glass thickness 6 - 10mm.
Available in polished and satin chrome.
Sold separately.

FINISH	CODE
Polished	JH704PC
Satin	JH704SC

90° Glass to Glass Shower Fixing

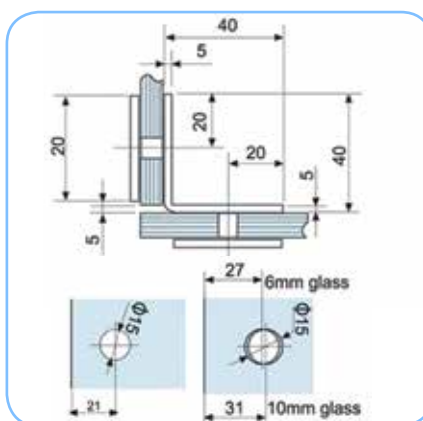

Suitable for glass thickness 6 - 10mm.
Available in polished and satin chrome.
Sold separately.

FINISH	CODE
Polished	JH705PC
Satin	JH705SC

135° Glass to Glass Shower Fixing

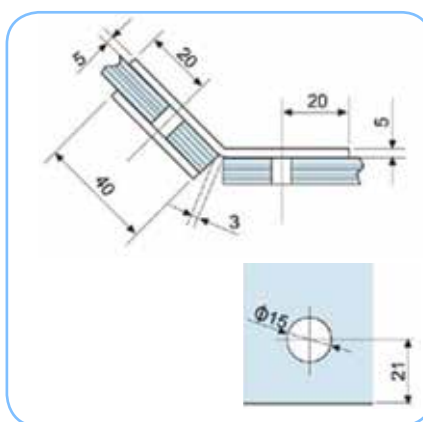

Suitable for glass thickness 6 - 10mm.
Available in polished and satin chrome.
Sold separately.

FINISH	CODE
Polished	JH706PC
Satin	JH706SC

T Glass to Glass Shower Fixing

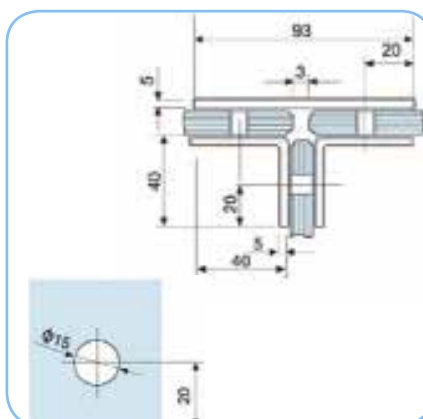

Suitable for glass thickness 6 - 10mm.
Available in polished and satin chrome.
Sold separately.

FINISH	CODE
Polished	JH707PC
Satin	JH707SC

Frameless Shower Hardware

Shower Door Knob

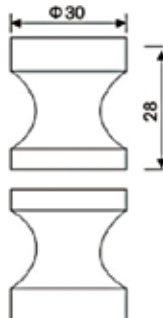

Knob suitable for shower doors. Available in polished and satin chrome. Suitable for 6 - 12mm thick glass.

FINISH	CODE
Polished	JKB603
Satin	JKB603SC

Shower Door Knob

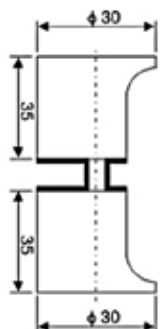

Knob suitable for shower doors. Available in polished and satin chrome. Suitable for 6 - 12mm thick glass.

FINISH	CODE
Polished	JKB604
Satin	JKB604SC

Shower Door Knob

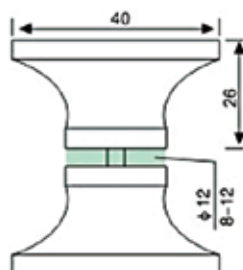

Knob suitable for shower doors. Available in polished and satin chrome. Suitable for 6 - 12mm thick glass.

FINISH	CODE
Polished	JKB609
Satin	JKB609SC

Shower Door Knob

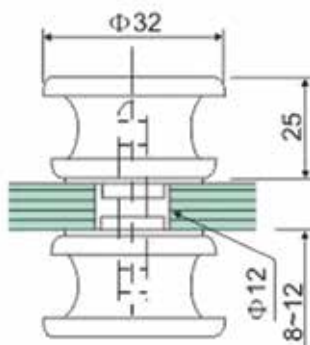

Knob suitable for shower doors. Available in polished and satin chrome. Suitable for 6 - 12mm thick glass.

FINISH	CODE
Polished	JKB691
Satin	JKB691SC

Frameless Shower Hardware

Shower Door Knob

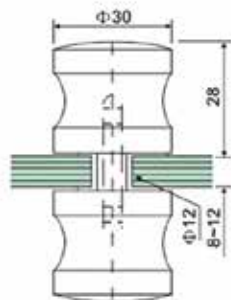

Knob suitable for shower doors. Available in polished and satin chrome. Suitable for 6 - 12mm thick glass.

FINISH	CODE
Polished	JKB692
Satin	JKB692SC

Shower Door Knob

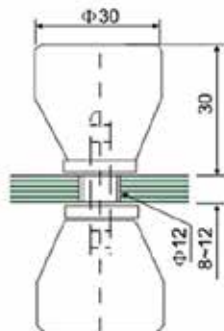

Knob suitable for shower doors. Available in polished and satin chrome. Suitable for 6 - 12mm thick glass.

FINISH	CODE
Polished	JKB693
Satin	JKB693SC

Shower Door Knob

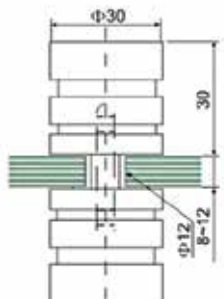

Knob suitable for shower doors. Available in polished and satin chrome. Suitable for 6 - 12mm thick glass.

FINISH	CODE
Polished	JKB694
Satin	JKB694SC

Shower Door Knob

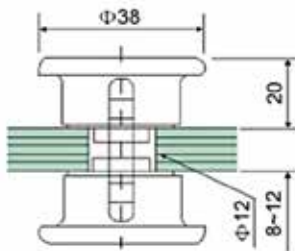

Knob suitable for shower doors. Available in polished and satin chrome. Suitable for 6 - 12mm thick glass.

FINISH	CODE
Polished	JKB695
Satin	JKB695SC

Frameless Shower Hardware

Shower Door Knob

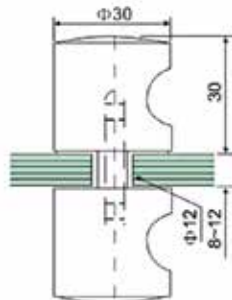

Knob suitable for shower doors. Available in polished and satin chrome. Suitable for 6 - 12mm thick glass.

FINISH	CODE
Polished	JKB696
Satin	JKB696SC

Shower Door Knob

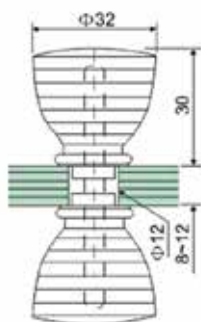

Knob suitable for shower doors. Available in polished and satin chrome. Suitable for 6 - 12mm thick glass.

FINISH	CODE
Polished	JKB697
Satin	JKB697SC

Shower Door Knob

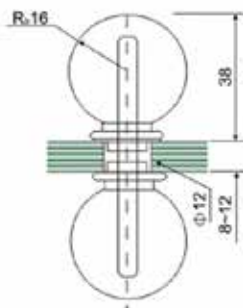

Knob suitable for shower doors. Available in polished and satin chrome. Suitable for 6 - 12mm thick glass.

FINISH	CODE
Polished	JKB698
Satin	JKB698SC

Door Angle Jamb With Seal



Polished aluminium angle jamb with seal. Pre drilled for mounting to wall.

CODE	JP001
------	-------

Frameless Shower Hardware

Telescopic Re-inforcing Bar



Telescopic re-inforcing bar which extends from 800 - 1000mm. Suitable for 8 - 12mm thick glass. Supplied in a polished chrome finish.

CODE | **JRB91PC**

Swivel Wall Connector

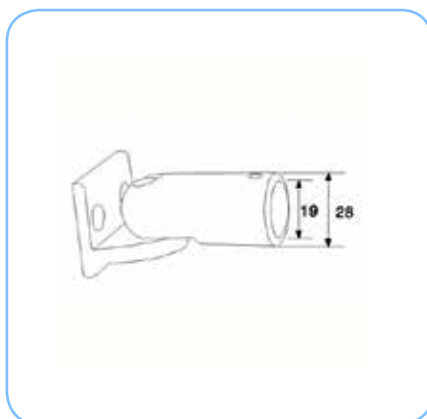

Enables the installer to install a reinforcing bar at nearly any angle. Works with the standard 19mm re-inforcing bars. Available in polished chrome.

CODE | **JRB92PC**

Swivel Glass Connector

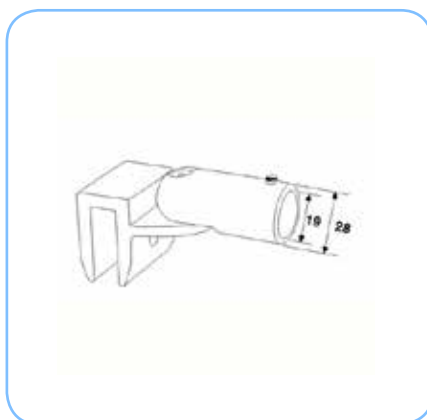

Enables the installer to install a reinforcing bar at nearly any angle. Suitable for 8 - 12mm thick glass. Works with the standard 19mm re-inforcing bars. Available in polished chrome.

CODE | **JRB93PC**

45° Telescopic Re-inforcing Bar

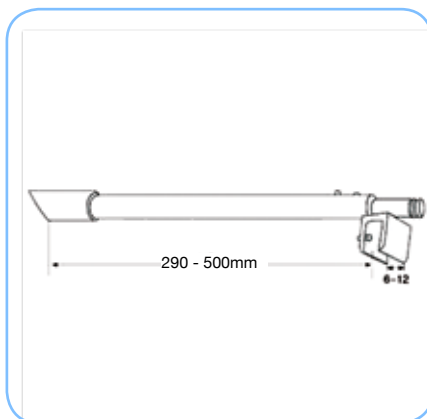

Suitable for installation at 45° to the panel that needs to be re-inforced. Suitable for 6 - 12mm thick glass. Available in polished chrome. Telescopic from 290 - 500mm long.

CODE | **JRB95PC**

Frameless Shower Hardware

Swivel Re-inforcing Bar

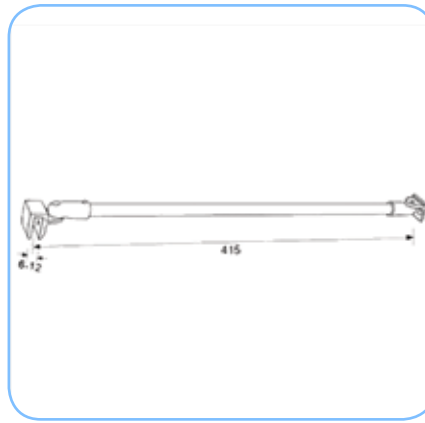

Suitable for installation at nearly any angle as it has both a swivel head and wall swivel installed. Available in polished chrome. 415mm long.

CODE	JRB96PC
------	----------------

90 ° Corner Connector

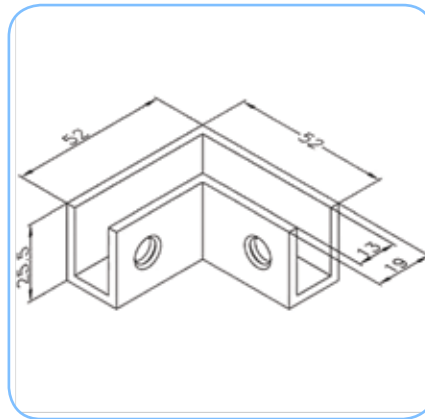

Ideal for connecting two fixed panels at 90° to each other. Polished chrome finish. Suitable for 8 - 12mm thick glass.

CODE	JRB97PC
------	----------------

Stainless Steel Pod Leg

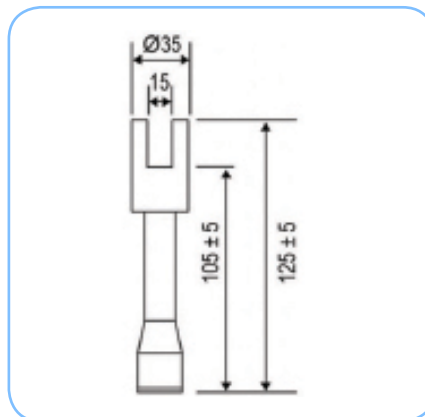

Stainless steel panel standoff, ideal for use in public shower/toilet areas where cleaning is made easier by standing the glass off the floor. Adjustable by +/- 5mm.

CODE	KP600
------	--------------

Black Toilet Cubicle Set



Ideal for toilets or dressing rooms. Suitable for material 16 - 18mm thick. Available in left and right hand doors. Manufactured using black polypropylene.

Set Consists Of:
2 Handles, 1 Hook, 1 Lock, 12 Angle Brackets With Cover Caps, 2 Legs With Cover Caps.

SIZE	CODE
Right	KPT001
Left	KPT002

Balustrade Clamps

45 x 45mm Flat Back Clamp

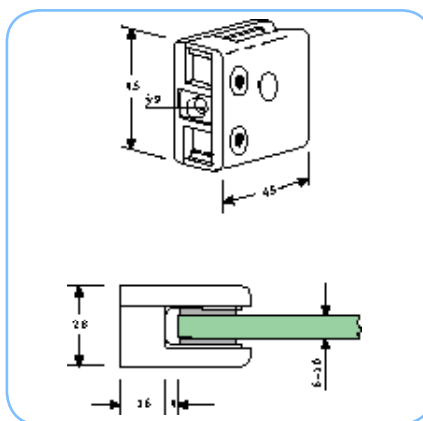

Available in both 304 & 316 stainless steel brushed finish. Suitable for 6 - 10mm thick glass.

MATERIAL	CODE
304 SS	K10050304
316 SS	K10050555

45 x 45mm Round Back Clamp - 42mm

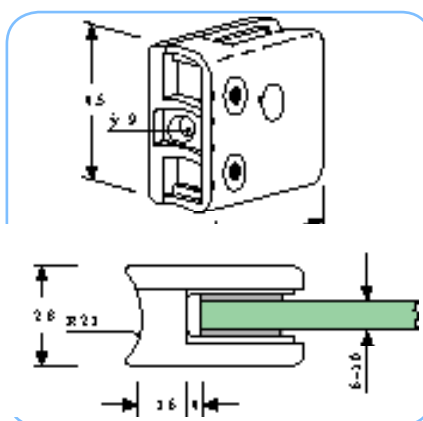

Available in both 304 & 316 stainless steel brushed finish. Suitable for 6 - 10mm thick glass. Suitable for mounting to a 42mm diameter post.

MATERIAL	CODE
304 SS	K10075304
316 SS	K10075555

45 x 45mm Round Back Clamp - 50mm

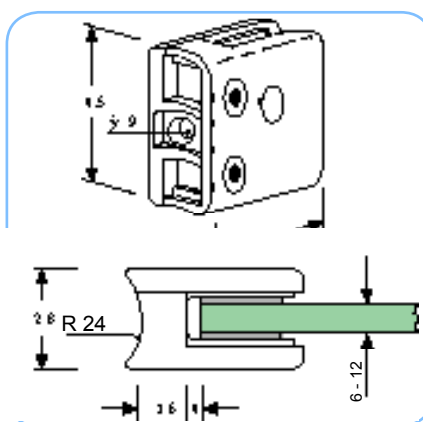

Available in both 304 & 316 stainless steel brushed finish. Suitable for 6 - 10mm thick glass. Suitable for mounting to a 48 - 50mm diameter post.

FINISH	CODE
304 SS	K10075304A
316 SS	K10075555A

63 x 45mm Flat Back Clamp

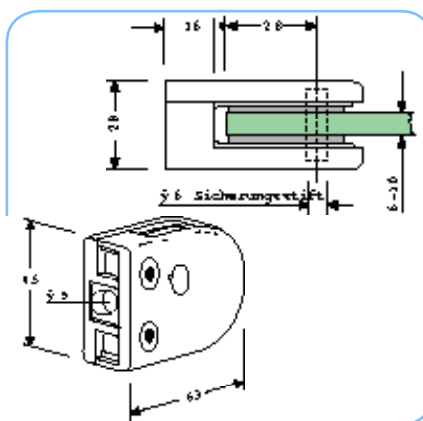

Available in 304, 316, 316L & 304 polished stainless steel. Suitable for 6 - 12mm thick glass. Suitable for mounting to a flat post or wall.

MATERIAL	CODE
304 SS	K10100304
316 SS	K10100555
316L SS	K10100555L
304 Polished	K10100555P

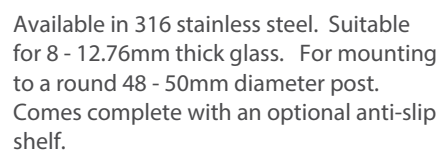
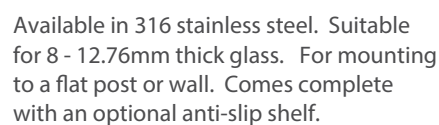
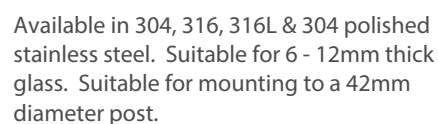
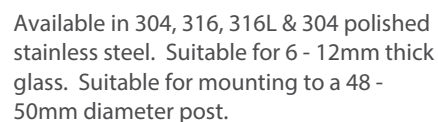
44

Balustrade Clamps & Point Fixings

67 x 55mm Flat Back Clamp

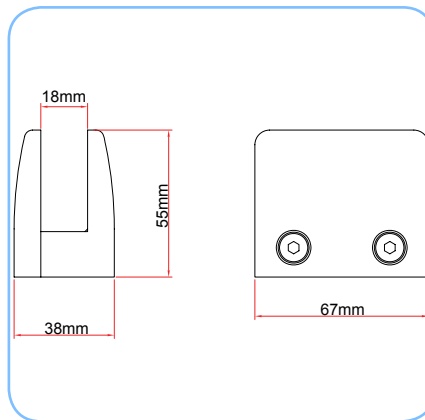

Available in 316 stainless steel. Suitable for 8 - 17.52mm thick glass. For mounting to a flat post or wall. Comes complete with an optional anti-slip shelf.

CODE	K105090004
------	-------------------

67 x 55mm Round Back Clamp - 50mm

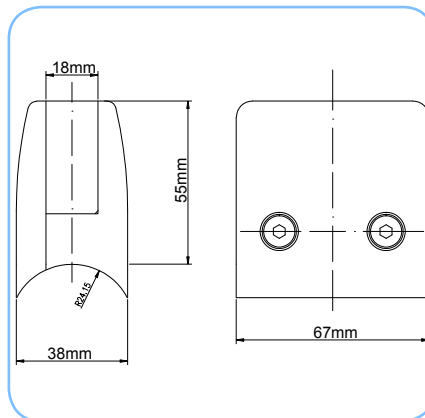

Available in 316 stainless steel. Suitable for 8 - 17.52mm thick glass. For mounting to a round 48 - 50mm diameter post. Comes complete with an optional anti-slip shelf.

CODE	K105094804
------	-------------------

30mm Diameter Point Fixtures

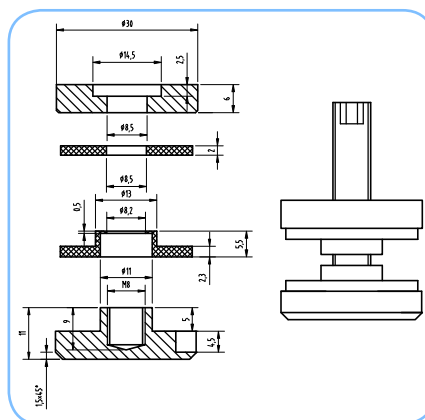

Suitable for mounting glass panels vertically or horizontally. 30mm diameter and available in both 304 & 316 satin stainless steel. Can be purchased with an optional wood screw (coach bolt) on request. Optional bolt lengths also available on request. Drill 16mm diameter hole in glass.

MATERIAL	CODE
304 SS	K10586511
316 SS	K105865116

50mm Diameter Point Fixture - M10

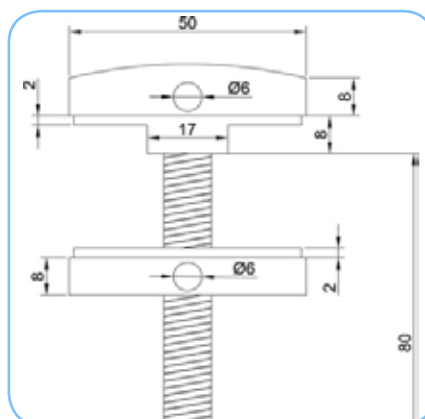

Suitable for mounting glass panels vertically or horizontally. 50mm diameter with an M10 bolt and available in both 304 & 316 satin stainless steel. Can be purchased with an optional wood screw (coach bolt) on request. Optional bolt lengths also available on request. Drill 16mm diameter hole in glass.

MATERIAL	CODE
304 SS	K17154512
316 SS	K171545126

50mm Diameter Point Fixture

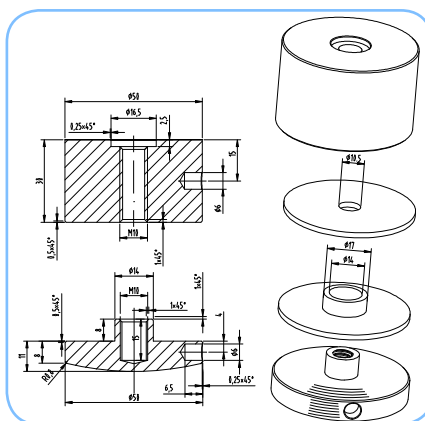

Suitable for mounting glass panels vertically or horizontally. 50mm diameter with an M10 bolt and a 30mm standoff. Available in both 304 & 316 satin stainless steel. Can be purchased with an optional wood screw (coach bolt) on request. Optional bolt lengths also available on request. Drill 20mm diameter hole in glass.

MATERIAL	CODE
304 SS	K17154530
316 SS	K171545306

50mm Diameter Point Fixture

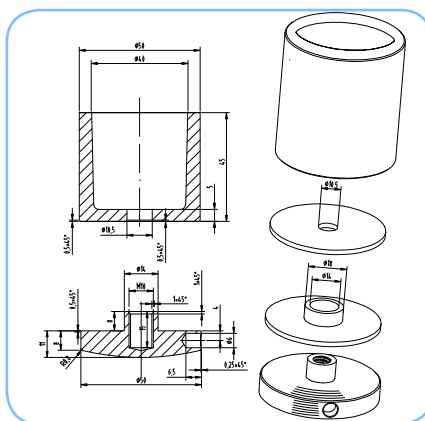

Suitable for mounting glass panels vertically or horizontally. 50mm diameter with an M10 bolt and a 45mm standoff. Available in both 304 & 316 satin stainless steel. Can be purchased with an optional wood screw (coach bolt) on request. Optional bolt lengths also available on request. Drill 20mm diameter hole in glass.

MATERIAL	CODE
304 SS	K17154545
316 SS	K171545456

50mm Diameter Point Fixture - M12

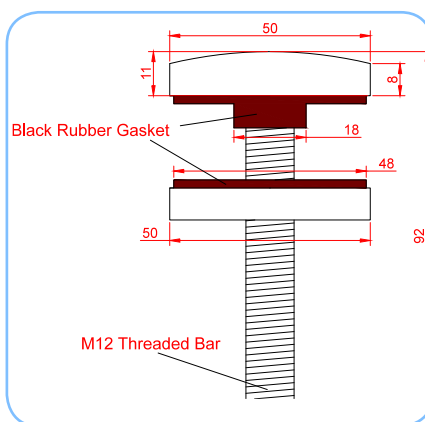

Suitable for mounting glass panels vertically or horizontally. 50mm diameter with an M12 bolt and available in both 304 & 316 satin stainless steel. Optional bolt lengths also available on request. Drill 20mm diameter hole in glass.

MATERIAL	CODE
304 SS	K17154512A
316 SS	K171545126A



F50 Ezi-Rail

Single Side Balustrade Post

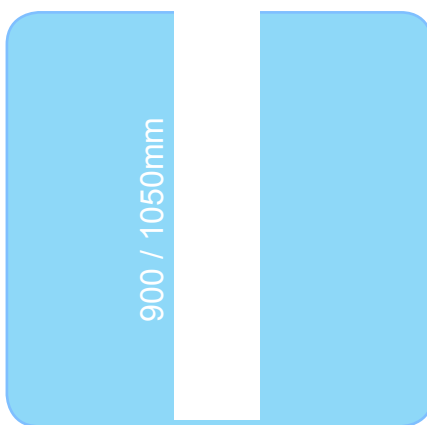

Single side 42mm diameter aluminium balustrade post with two 316 stainless steel balustrade brackets. Suitable for 6 - 12mm thick glass. Come complete with handrail bracket attached. Available in two standard heights 900mm and 1050mm which become 950mm and 1100mm respectively when handrail is added. Bespoke sizes and options available.

HEIGHT	CODE
900mm	KF50PRSE09
1050mm	KF50PRES10

Double Side 180° Balustrade Post



Double side 42mm diameter aluminium balustrade post with four 316 stainless steel balustrade brackets. Suitable for 6 - 12mm thick glass. Come complete with handrail bracket attached. Available in two standard heights 900mm and 1050mm which become 950mm and 1100mm respectively when handrail is added. Bespoke sizes and options available.

HEIGHT	CODE
900mm	KF50PRED09
1050mm	KF50PRED10

Double Side 90° Balustrade Post

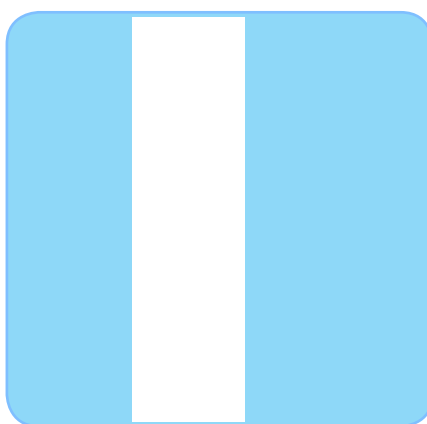

Double side 42mm diameter aluminium balustrade post with four 316 stainless steel balustrade brackets. Suitable for 6 - 12mm thick glass. Come complete with handrail bracket attached. Available in two standard heights 900mm and 1050mm which become 950mm and 1100mm respectively when handrail is added. Bespoke sizes and options available.

HEIGHT	CODE
900mm	KF50PRER09
1050mm	KF50PRER10

50mm Aluminium Round Handrail

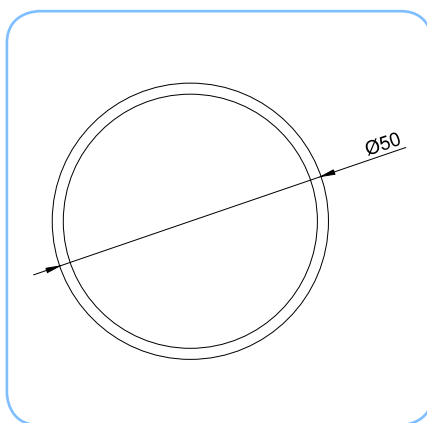
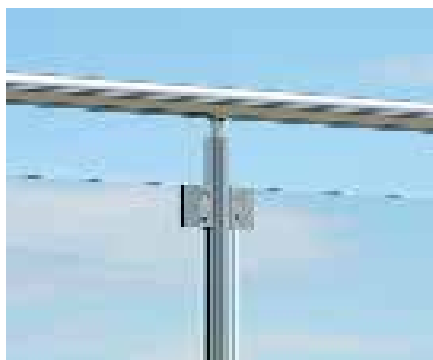

50mm aluminium handrail for fitting to the above balustrade posts. Easily fixed by means of self tapping screws. Stainless steel look with better anti-corrosion properties. Available as standard in 3 metre lengths but may be supplied in 6 metre lengths on request.

CODE	KF50-200
------	-----------------

KF85-B Adjustable on floor glass support system



ADJUSTABLE ON FLOOR GLASS SUPPORT SYSTEM

Adjustable on floor glass supporting system with aluminium profiles, ideal for the construction of glass railings on a floor or parapet. Bases are placed on a special guide for better support and system adjustment. Caps and covers are placed over the clamps for a high quality complete finish. The system is suitable for 16 or 20mm glass thickness and up to 1100mm high. Three glass clamp per linear metre is required.

ADVANTAGES

Vertical & Horizontal Adjustment
Special Guide For Bases
Glazing Support By Lateral Pressure Plates
Suitable For 16 or 20mm Glass
UNI EN10807 & NF P01-013

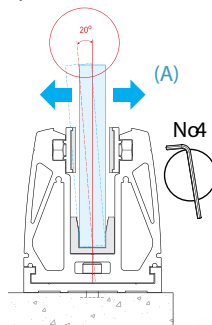

EASY ASSEMBLY

For a 1000mm wide piece of glass, three base clamps should be used. These are placed on a special aluminium guide track and fixed in position. The glass is inserted, the clamps tightened and then the endcaps and side covers are attached.

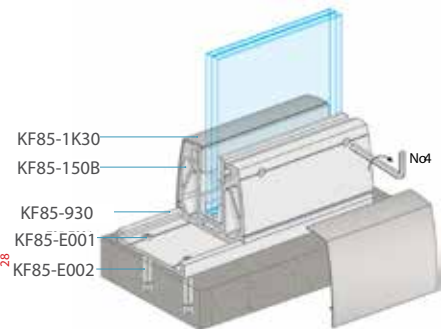
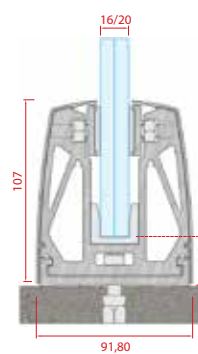

FIX BOTTOM TRACK & CLAMPS

INSERT, FIX & ADJUST THE GLASS

ATTACH SIDE AND END COVERS

FINISHED JOB



Crystalline Balustrade Systems

KF85-CU In-floor glass support system



IN-FLOOR GLASS SUPPORT SYSTEM

The in-floor glass support system is placed in the ground. The base is covered by aluminium covers and special waterproof gaskets at the same level as the final floor. This system is suitable for 16 or 20mm thick glass at a height up to 1100mm. Three glass clamps per linear metre is required.

ASSEMBLY STEPS

Firstly, the special guide is placed in the ground where the in-floor glass support system will be fixed. The concrete is poured around the perimeter of the guide while the final height is adjusted, according to the final floor's height by using an additional profile. Once the final floor is settled, the covers and the waterproof gaskets are fixed.

1. Place and adjust the depth of the floor base according to the height of the finished floor.
2. Pour the concrete around the perimeter of the floor guide
3. Insert the in-floor base and fix the glass and waterproof gaskets and aluminium covers.

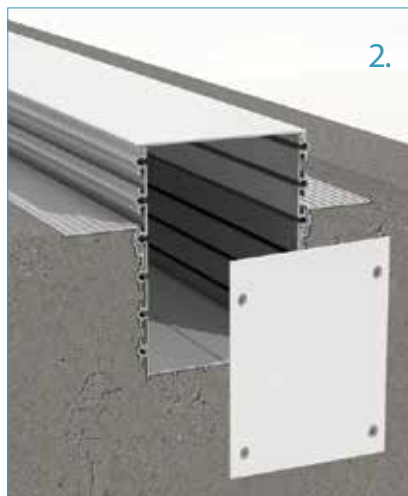
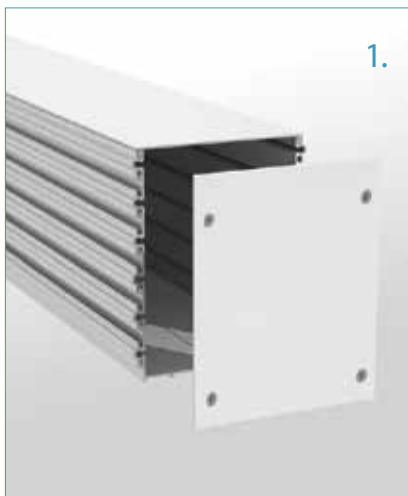
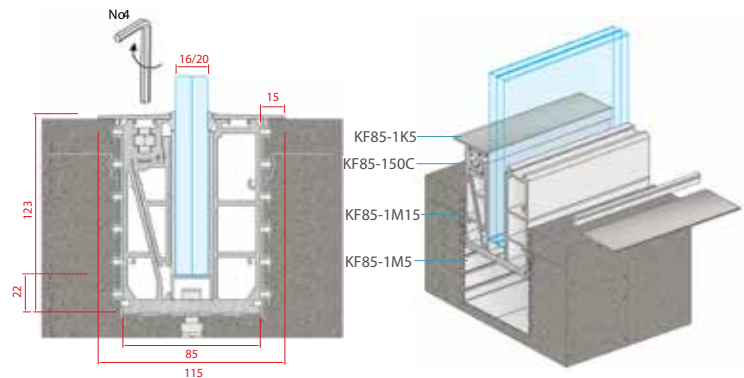



EXTERNAL GLASS SUPPORT SYSTEM

The base profile which will support the glass of 16, 20 or 24mm thickness and up to 1100mm high is bolted on to the wall. The external base is screwed on to the parapet where the glass is fixed by special metal fixings. Depending on the system selected covers may be applied. Four glass fixings per linear metre is required.

ASSEMBLY STEPS

1. Bolt The External base on to the parapet
2. Place and adjust the glass and bolt with glass fixings.
3. Fix the additional aluminium covers if required.

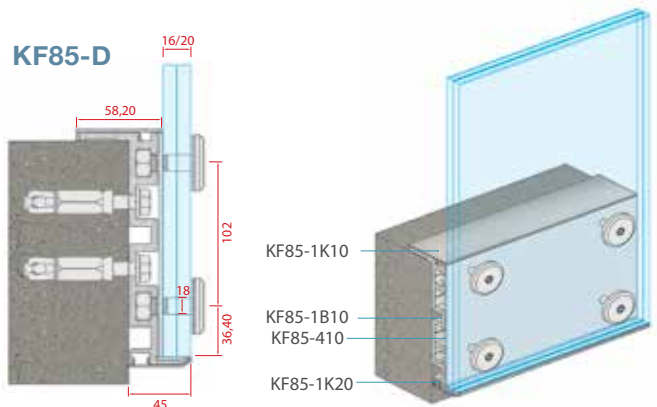

KF85-DC

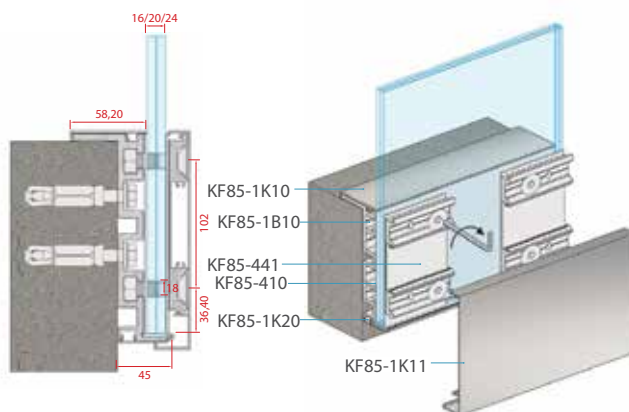

KF85-DCA

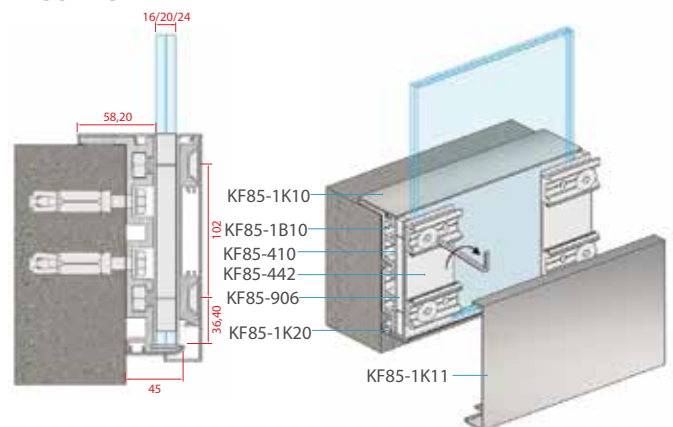

Bi-Fold Sliding Glass Wall System

Bi-Fold Top Track

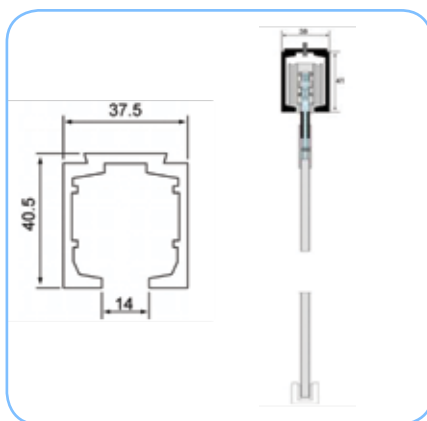

Anodised aluminium sliding track supplied in 3 metre lengths.



CODE **KBF010**

Bi-Fold Lock & Glass Receiver

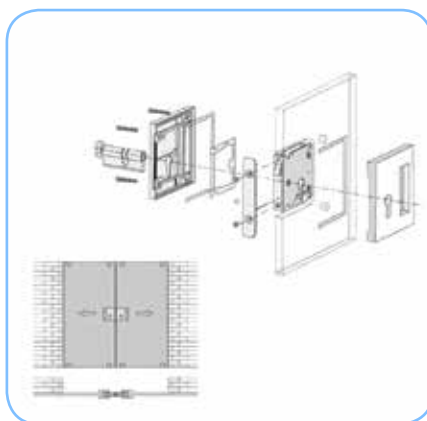

Lock and receiver set for locking any sliding door or wall to a fixed glass panel. Supplied in stainless steel.

CODE **KBF01A**

Bi-Fold Lock & Wall Receiver

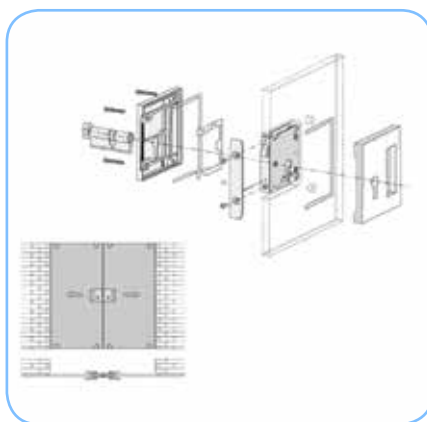

Lock and receiver set for locking any sliding door or wall to a fixed glass panel. Supplied in stainless steel.

CODE **KBF01B**

Bi-Fold Top Folding Hanger

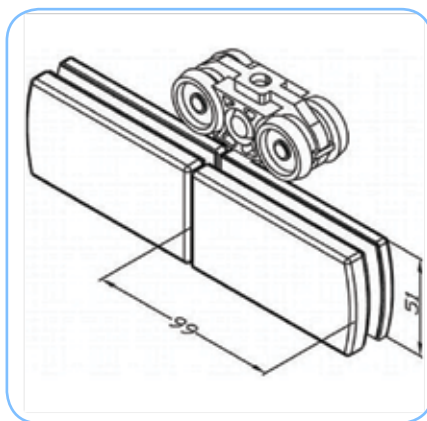

Top folding hanger manufactured using high quality stainless steel.

CODE **KBF02T**

Bi-Fold Sliding Glass Wall System

Bi-Fold Top Folding End Hanger

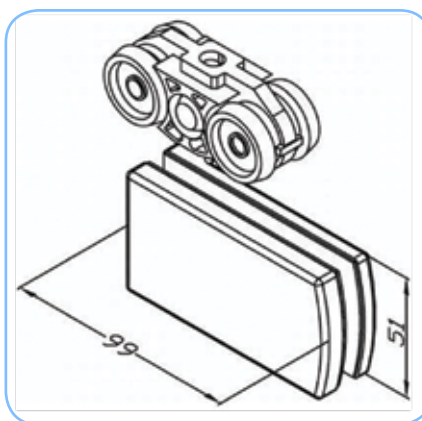

Top folding hanger manufactured using high quality stainless steel.

CODE | **KBF03T**

Bi-Fold Bottom Folding Anchor

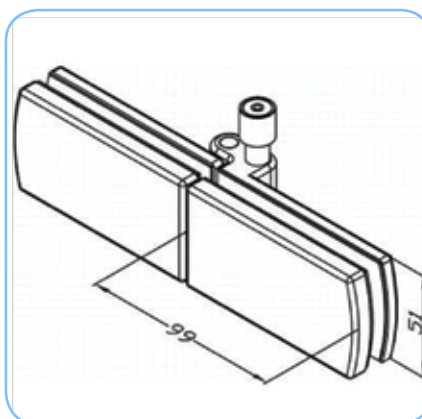

Top folding anchor manufactured using high quality stainless steel. Guides the Bi-Fold system along the bottom track.

CODE | **KBF04T**

Bi-Fold Bottom End Anchor Pivot

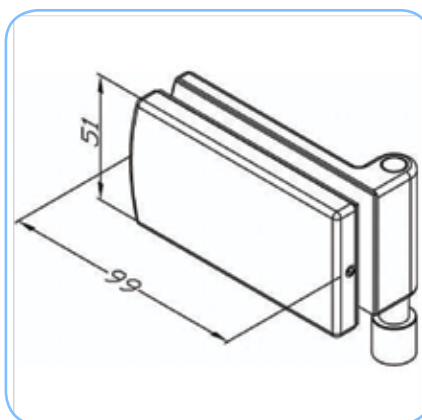

Top folding anchor manufactured using high quality stainless steel. Guides the Bi-Fold system along the bottom track.

CODE | **KBF05T**

Bi-Fold Top Anchor Mount

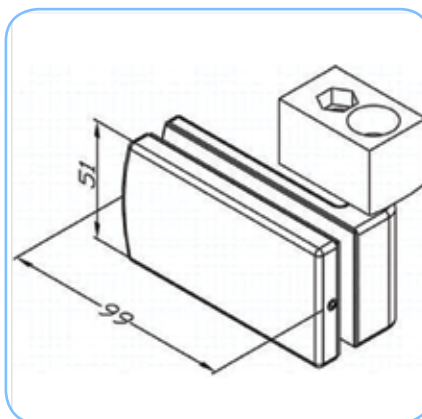

Top pivot manufactured using high quality stainless steel. Used to mount the end panel.

CODE | **KBF06T**

Bi-Fold Sliding Glass Wall System

Bi-Fold Bottom Free Fold

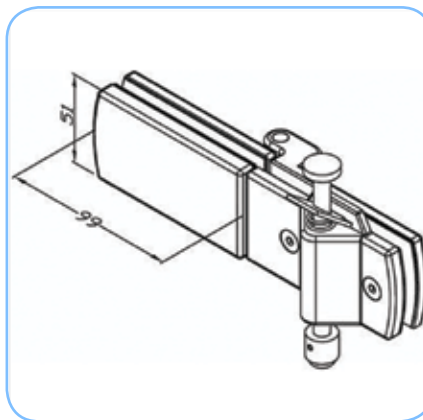

Bottom folding hinge manufactured using high quality stainless steel. Can hold panels in any position open or closed by applying the brake system by foot and easy release pedal.

CODE

KBF07T

Bi-Fold Top Free Fold

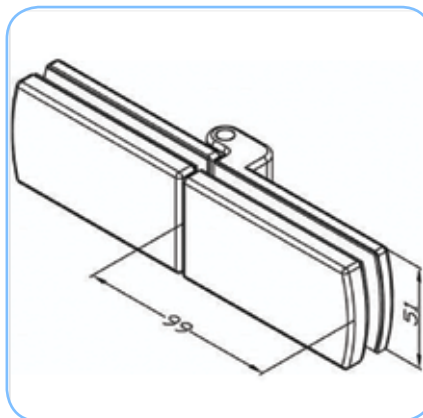

Top folding hinge manufactured using high quality stainless steel. Attaches the panel sides away from the upper track.

CODE

KBF08T

Bi-Fold Bottom Anchor Mount

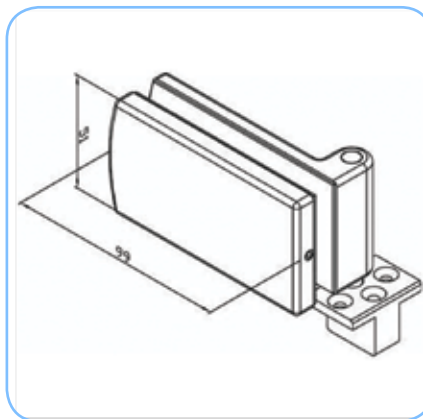

Bottom anchor mount hinge manufactured using high quality stainless steel. Used in the end panel and installs into the bottom track.

CODE

KBF10T

Bi-Fold Bottom Guide Track

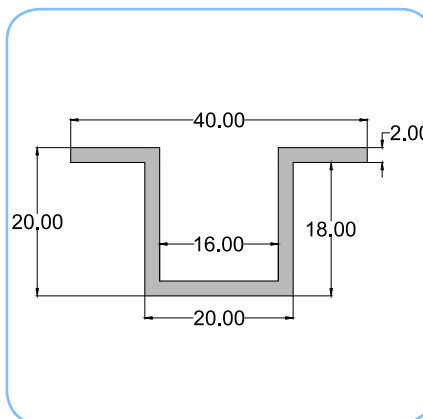

Aluminium bottom track used in conjunction with the bi-fold system. Supplied in three metre lengths.

CODE

KBF102

Lever Locks & Receivers

Lever Lock One Way Receiver

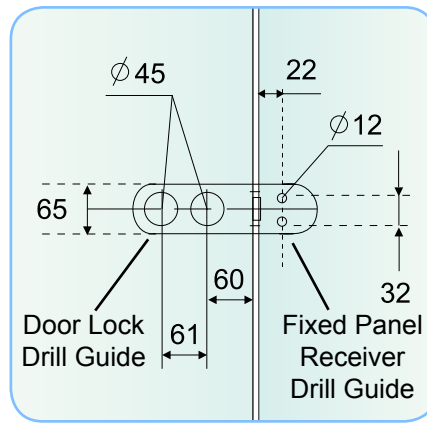

Lever lock one way glass panel receiver in both stainless steel or aluminium covers. Can be used on the right or left hand side and inside or outside.

Material	Finish	CODE
Stainless	Polished	KLL20KSPS
Stainless	Satin	KLL20KSSS
Aluminium	Silver	KLL20KMS
Aluminium	Brass	KLL20KMB
Aluminium	SS Effect	KLL20KSNK

One Way Lever Lock

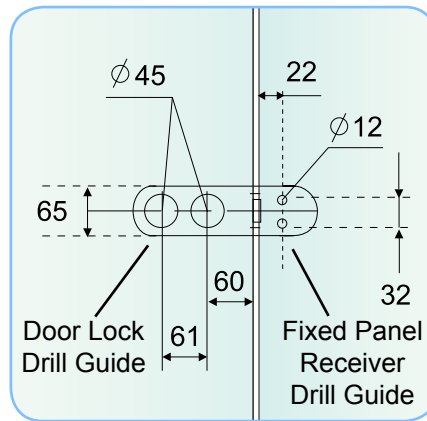

Glass door lever lock for use with the above receiver. Available in both stainless steel or aluminium covers. Can be used on the right or left hand side and inside or outside. Handle and lock cylinder purchased separately.

Material	Finish	CODE
Stainless	Polished	KLL20SPS
Stainless	Satin	KLL20SSS
Aluminium	Silver	KLL20MS
Aluminium	Brass	KLL20MB

One Way Lever Lock - Non Lockable

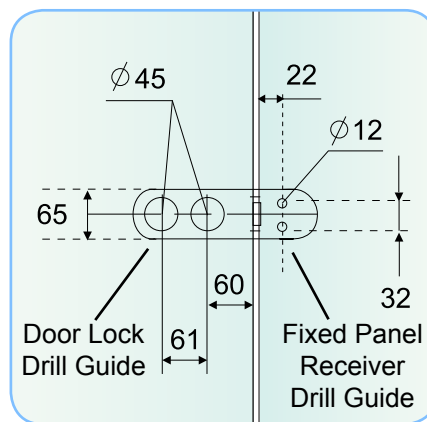

Glass door lever lock for use with the above receiver. Available in both stainless steel or aluminium covers. Can be used on the right or left hand side and inside or outside. Handle purchased separately.

Material	Finish	CODE
Stainless	Satin	KLL21SSS
Aluminium	SS Effect	KLL21SNK
Aluminium	Silver	KLL21MS
Aluminium	Brass	KLL21MB

Two Way Lever Lock Receiver

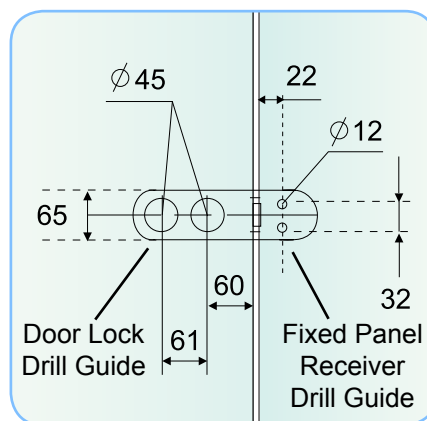

Lever lock two way glass panel receiver in both stainless steel or aluminium covers. Can be used on the right or left hand side and inside or outside. Used where a door can be opened both in and out.

Material	Finish	CODE
Stainless	Satin	KLL22KSS
Aluminium	SS Effect	KLL22KSNK

Lever Locks & Receivers

Two Way Lever Lock

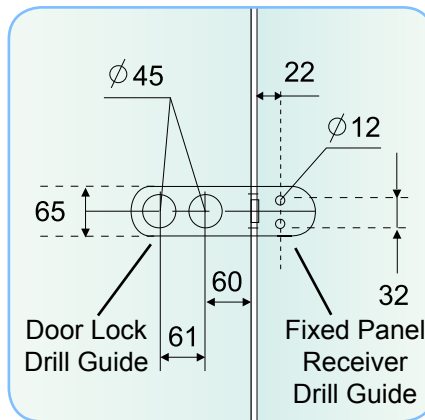

Glass door lever lock for use with the previous receiver. Available with both stainless steel or aluminium covers. Handle and lock cylinder purchased separately. Door can be opened both in and out.

Material	Finish	CODE
Stainless	Satin	KLL22SSS
Aluminium	SS Effect	KLL22SNK
Aluminium	Silver	KLL22MS
Aluminium	Brass	KLL22MB

Two Way Lever Lock - Non Lockable

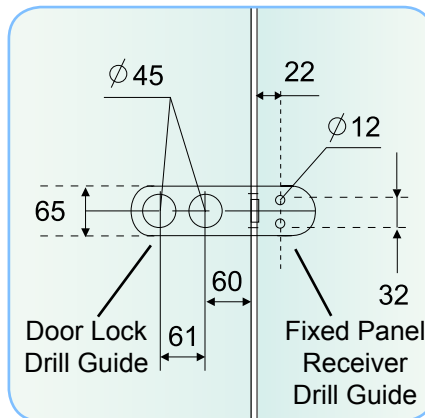

Glass door lever lock for use with the previous receiver. Available with both stainless steel or aluminium covers. Handle purchased separately. Door can be opened both in and out. Non Lockable.

Material	Finish	CODE
Stainless	Satin	KLL23SSS
Aluminium	SS Effect	KLL23SNK
Aluminium	Silver	KLL23MS
Aluminium	Brass	KLL23MB

Lever Lock Handle

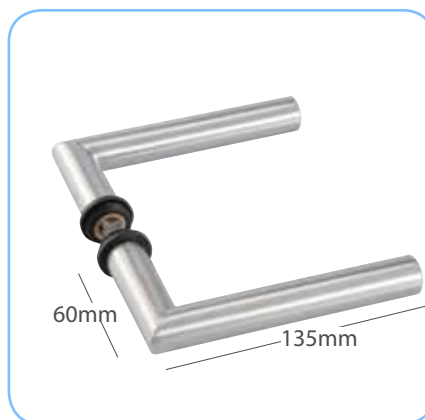

Top quality stainless steel lever handle for use with the previous lever locks. Available in both polished and satin stainless steel. 20mm diameter.

FINISH	CODE
Polished	KLLD201PS
Satin	KLLD201SS

Lever Lock Handle



Top quality stainless steel lever handle for use with the previous lever locks. Available in both polished and satin stainless steel.

FINISH	CODE
Polished	KLLD202PS
Satin	KLLD202SS